



弘典企業有限公司 HORNG DEAN ENTERPRISE LTD.

# 鉻銅圓板

## Chrome copper Disk



產品標準規格表列如下：  
(Specification)

尺寸單位：mm  
(Unit)

直徑D* Diameter	100	120	150	200	250	280	300	320	350	400
厚度T Thickness										
8							✓			
10							✓			
12	✓	✓	✓	✓	✓	✓	✓	✓	✓	✓

材 質	Material
鉻 銅	Cr Cu
鉻鋯銅	CrZrCu
鈹 銅	Be Cu

備註：如有特殊規格，歡迎訂製。

(If you need special specs,welcome to order custom-made)



弘典企業有限公司 HORNG DEAN ENTERPRISE LTD.

# 鉻銅銅條

## Round Bars

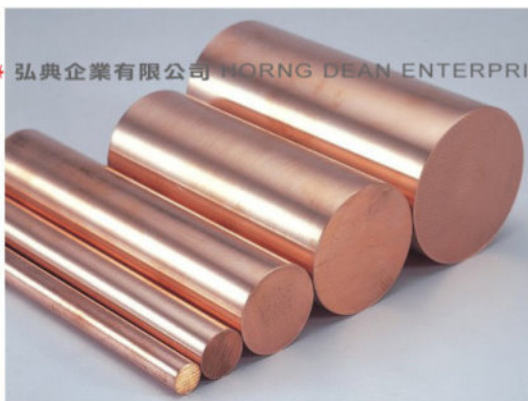

產品標準規格表列如下：  
(Specification)

尺寸單位：mm  
(Unit)

直徑D* Diameter	2	3	4	5	6	8	10	12	13	16	19	22	25	28	32
長度L Length															
500															
1000	✓	✓	✓	✓	✓	✓	✓	✓	✓	✓	✓	✓	✓	✓	✓
直徑D* Diameter	35	38	42	45	50	60	70	80	90	100	110	120	130	140	150
長度L Length															
500													✓	✓	✓
1000	✓	✓	✓	✓	✓	✓	✓	✓	✓	✓	✓	✓			

材 質	Material
鉻 銅	Cr Cu
鉻鋯銅	CrZrCu
鈹 銅	Be Cu
鋁 銅	Al Cu

備註：如有特殊規格，歡迎訂製。

(If you need special specs,welcome to order custom-made)

# 鉻銅角材 **Chrome Copper Plate**



材 質	Material
鉻 銅	Cr Cu
鉻鋯銅	CrZrCu
鈹 銅	Be Cu

 弘典企業有限公司 HORNG DEAN ENTERPRISE LTD.

產品標準規格表列如下：  
(Specification)

尺寸單位：mm  
(Unit)

寬度 Width × 長度 Length	305 × 500	305 × 1000	50 × 1000	60 × 1000	70 × 1000	70 × 3800	80 × 1000	38 × 1000	40 × 1000
厚度 Thickness									
2		✓							
3		✓							
4		✓							
5		✓							
6		✓							
8		✓							
10		✓							
12		✓							
16		✓		✓	✓				
20		✓	✓	✓	✓	✓	✓		
25		✓		✓	✓				
32		✓							
35		✓							
38								✓	
40	✓	✓							✓
45	✓	✓							
50	✓	✓							
60	✓	✓							
70	✓	✓							
80	✓	✓							

備註：另有較寬或較長之尺寸可供應，歡迎來電洽詢。  
Welcome to ask us if you need wider or longer size

# 電極銅頭 **Spot tip**

產品標準規格表列如下：  
(Specification)

尺寸單位：mm  
(Unit)

D $\phi$	13	16	19	19	25	32
L	50	53	56	56	56	56
TAPER	13 1/10	16 1/10	16 1/10	19 1/10	16 1/10	16 1/10

備註：如有特殊規格，歡迎訂製。  
(If you need special specs, welcome to order custom-made)

材 質	Material
鉻 銅	Cr Cu
鉻鋯銅	CrZrCu
鈹 銅	Be Cu
鋁 銅	Al Cu

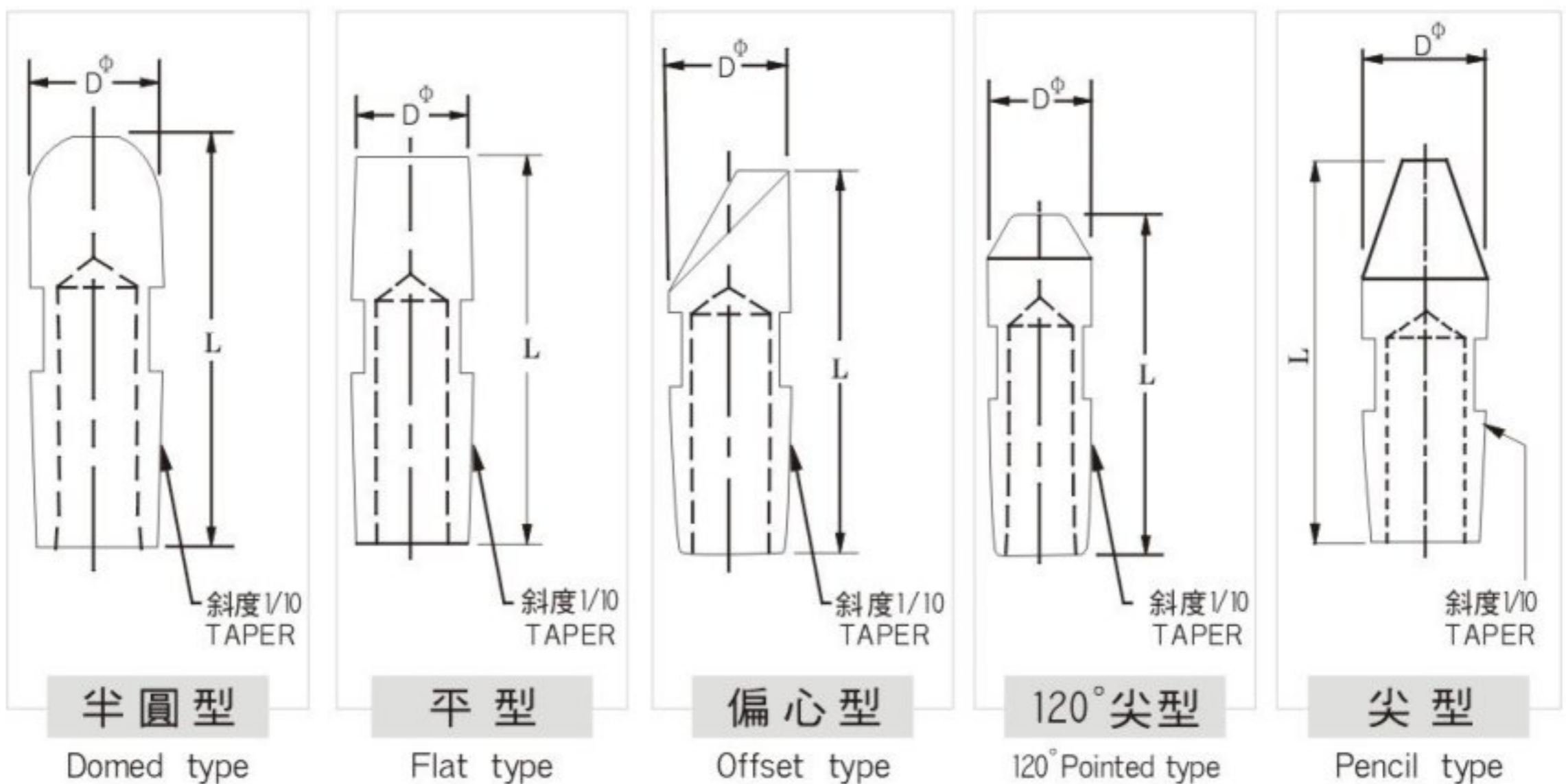

# 焊帽及焊帽接桿 Cap Tips And Shank



HD 弘典企業有限公司 HONG DIAN ENTERPRISE LTD.

半圓型  
Domed type

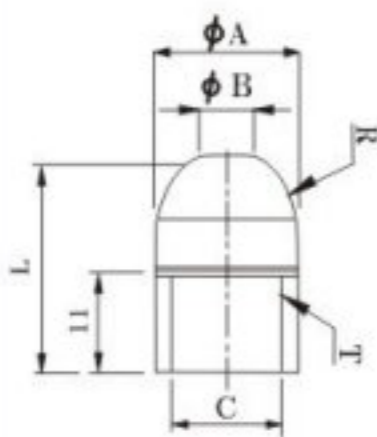

尖型  
Pencil type

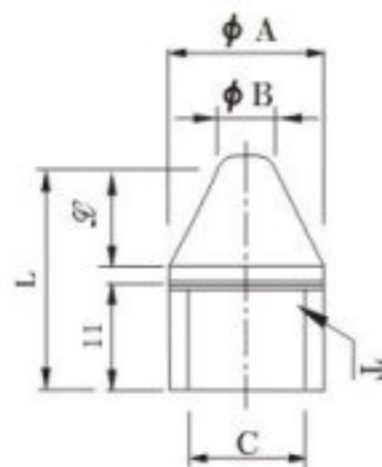

平型  
Flat type

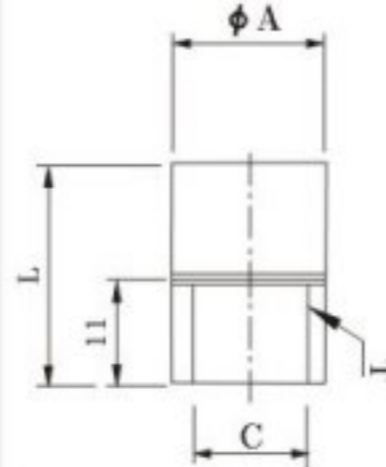

偏心型  
Offset type

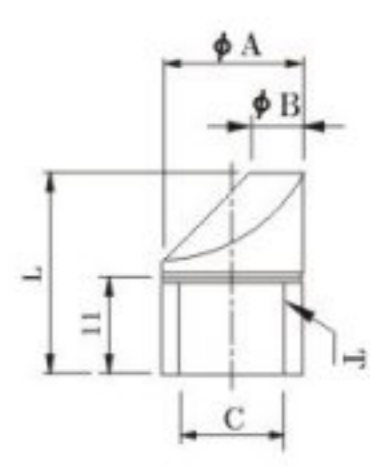

焊帽標準規格表列如下：  
(Specification)

尺寸單位：mm  
(Unit)

A $\phi$	B $\phi$	R	D	T	C	L
13	6	6.5R	9	1/10	10	23
16	6	8R	9	1/10	12.3	23

備註：如有特殊規格，歡迎訂製。  
(If you need special specs, welcome to order custom-made)

材質	Material
鉻銅	Cr Cu
鉻鋯銅	CrZrCu
鋁銅	Al Cu

焊帽接桿標準規格表列如下：  
(Specification)

尺寸單位：mm  
(Unit)

d $\phi$	D $\phi$	材質	Material
10	16 1/10	鉻銅	Cr Cu
12.3	16 1/10	鈹銅	Be Cu

備註：如有特殊規格，歡迎訂製。  
(If you need special specs, welcome to order custom-made)

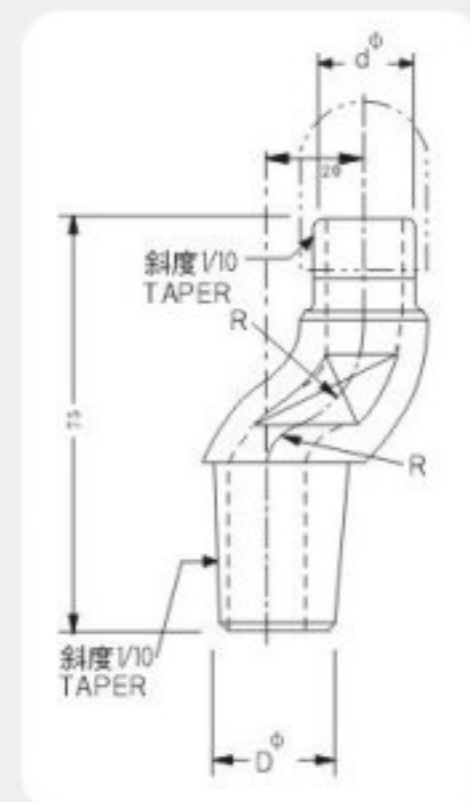
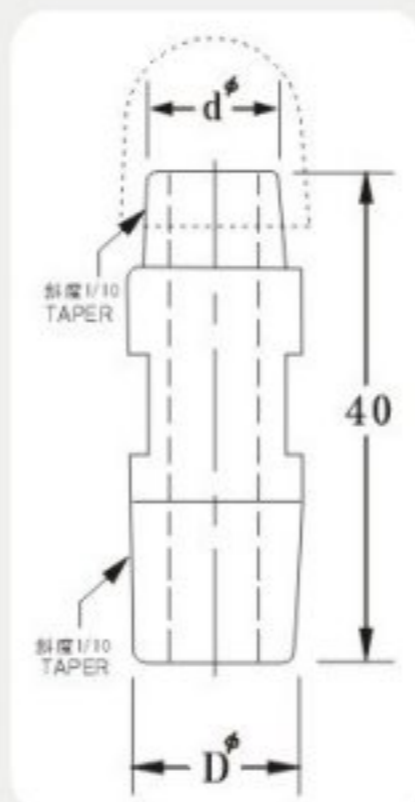

# 電極拔取器

A Device to pulled out pole

全長：220mm 重量：340g

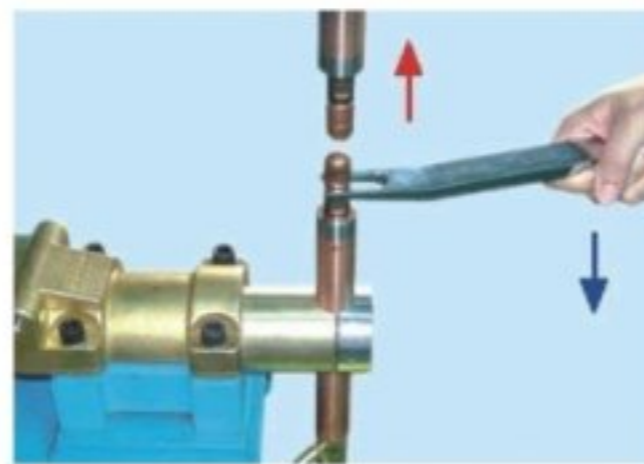
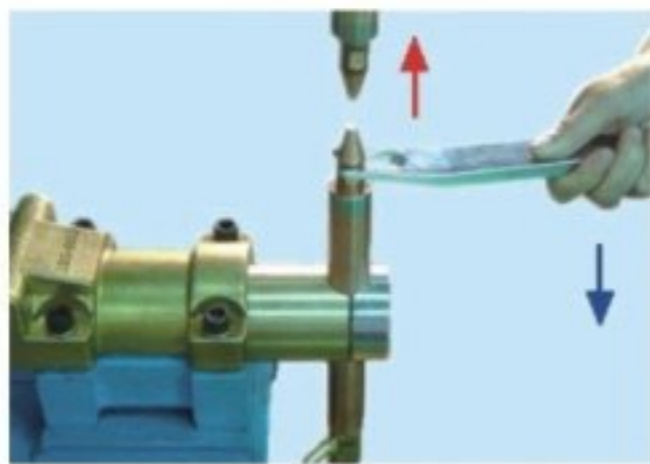
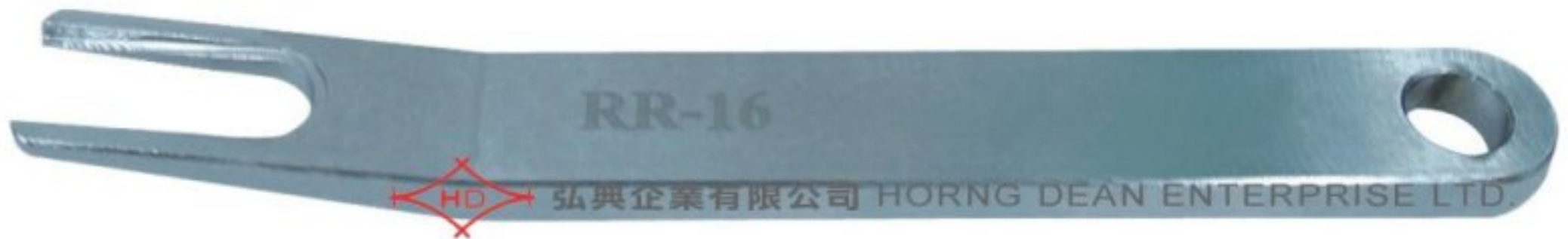

使用方法

型式Type	焊帽口徑 Cap tips size
RR-13	ø12, ø13
RR-16	ø16

全長：220mm 重量：340g



左端使用方法

右端使用方法

型式Type	焊帽口徑 Cap tips size
RO-13-25	ø8 ~ ø16
RO-16-25	ø8 ~ ø16
RO-13-35	ø10 ~ ø20
RO-16-35	ø10 ~ ø20

# 電極修整器 **Tip Dresser**



弘典企業有限公司 HORNG DEAN ENTERPRISE LTD.

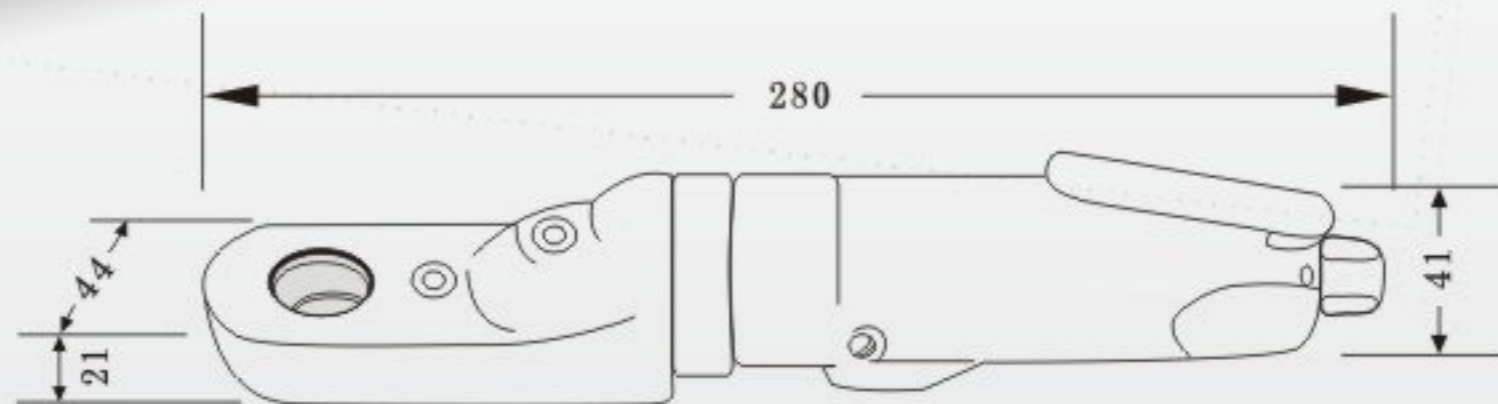

## 產品特點

1. 小型輕量、操作簡便
2. 自動中心對正
3. 刀座、刀片更換容易
4. 低空氣消耗量
5. 電極外徑 $D\phi 13\sim 16\text{mm}$ .
6. 空載回轉數1300r.p.m.
7. 重量1.3kg

## FEATURES

1. Small, light and simple to operate
2. Center, autosearch
3. Easy to change holder and tip.
4. Low air consumption.
5. Electrode  $D\phi 13\sim 16\text{mm}$ .
6. No load 1300 r.p.m.
7. Weight 1.3kg.

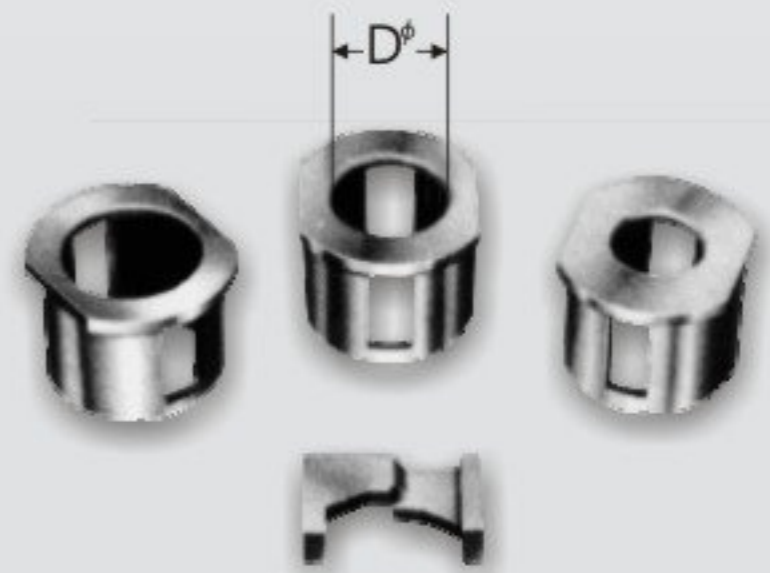

## WTD-18F

型式 Shape	刀座 Dφ	刀片 Aφ×R
	13φ	6.5R
	16φ	8 R

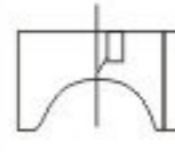
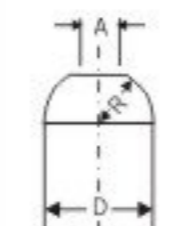
型式 Shape	刀座 Dφ	刀片 Aφ×R
	13φ	5φ X 6.5R
	16φ	6φ X 8R

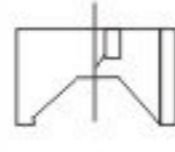
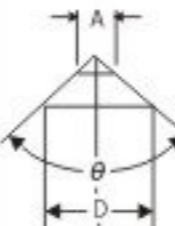
型式 Shape	刀座 Dφ	刀片 Aφ×R
	13φ	5φ X 60°
	16φ	6φ X 75°

# 彎形及萬向電極銅頭

Bending shape and 360° angle  
Electrode shank

EK-R-1 萬向  
360° angle



 弘典企業有限公司 HORNG DEAN ENTERPRISE LTD.

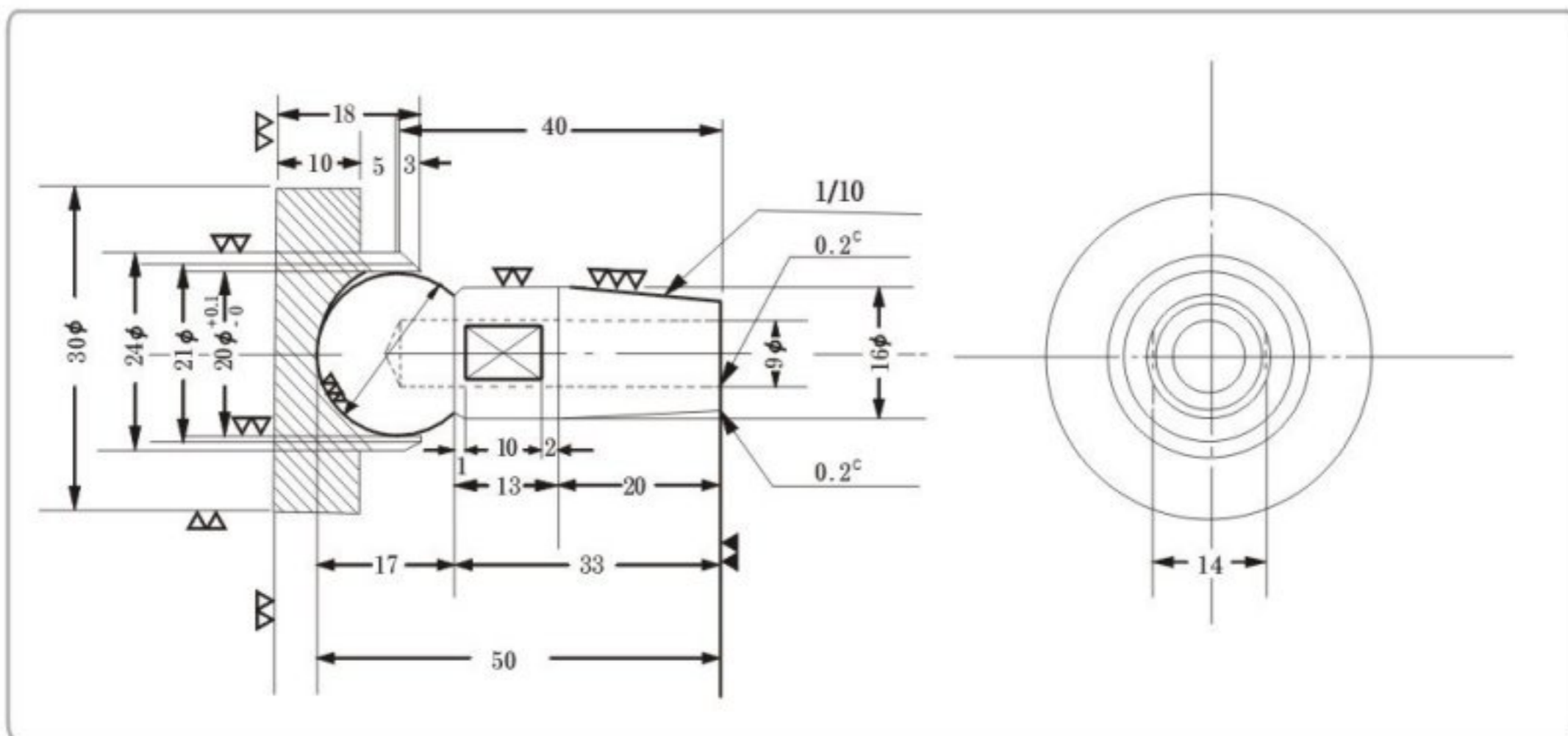

EK-C-2-2 中彎  
Two point bent

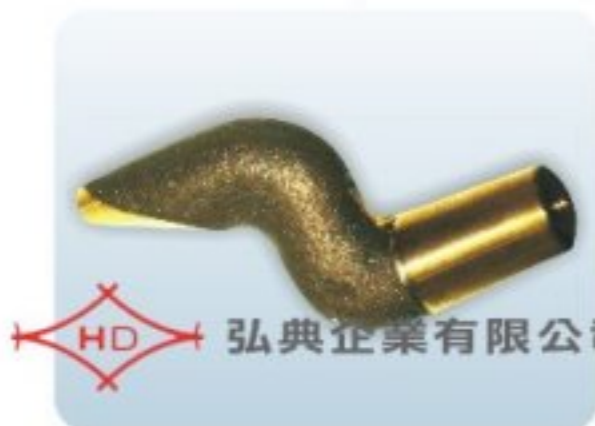

 弘典企業有限公司 HORNG DEAN ENTERPRISE LTD.

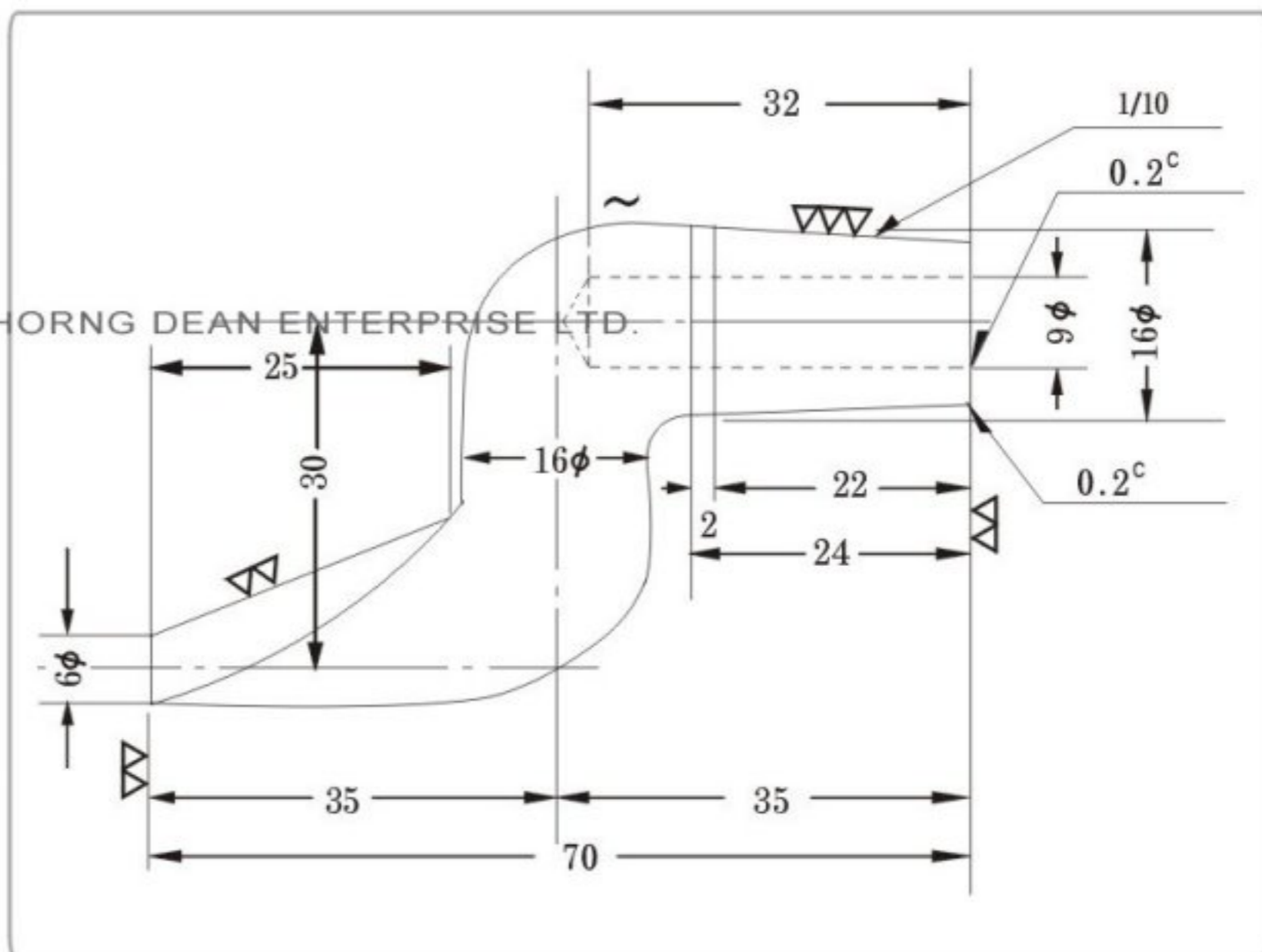

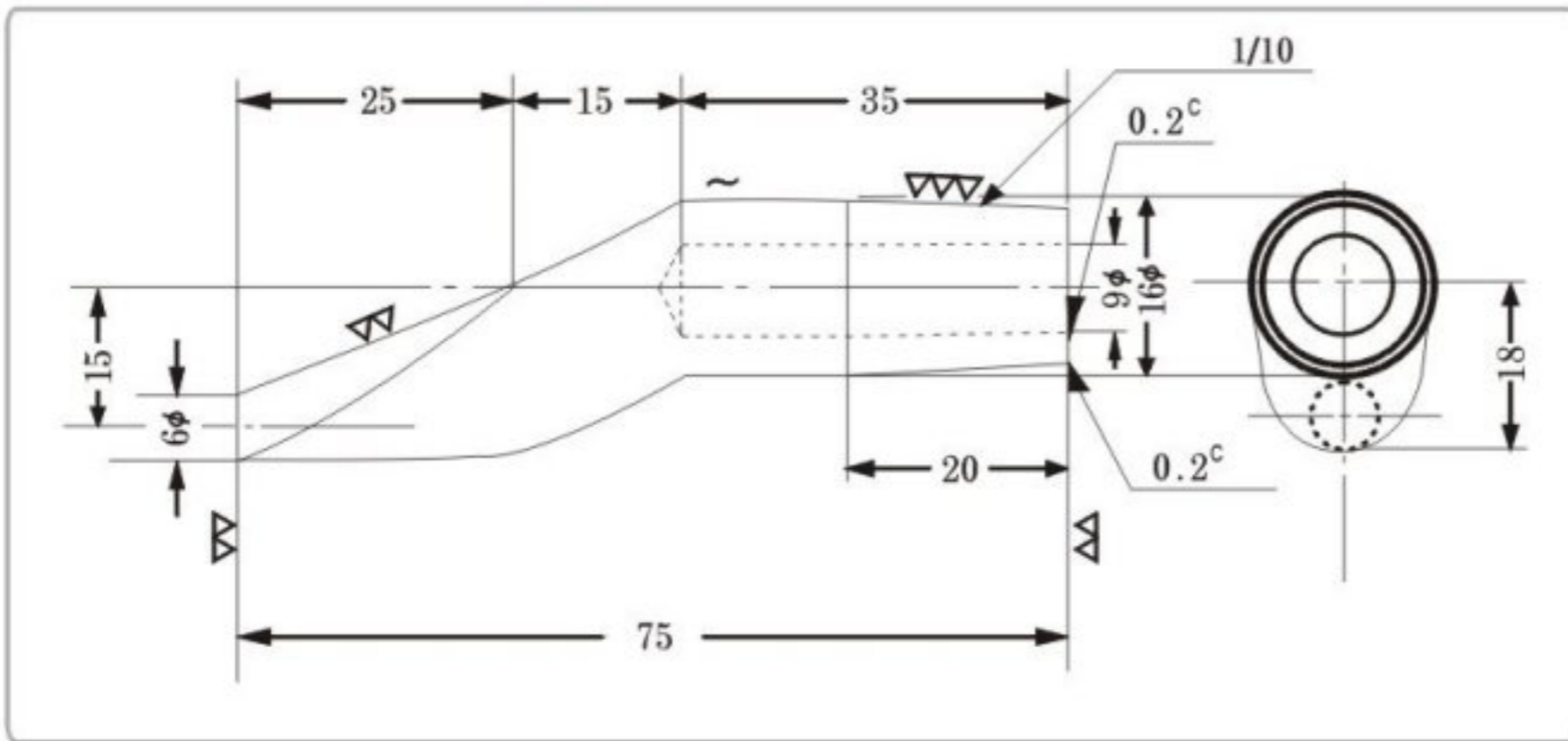

EK-C-1-2 小彎  
One point bent

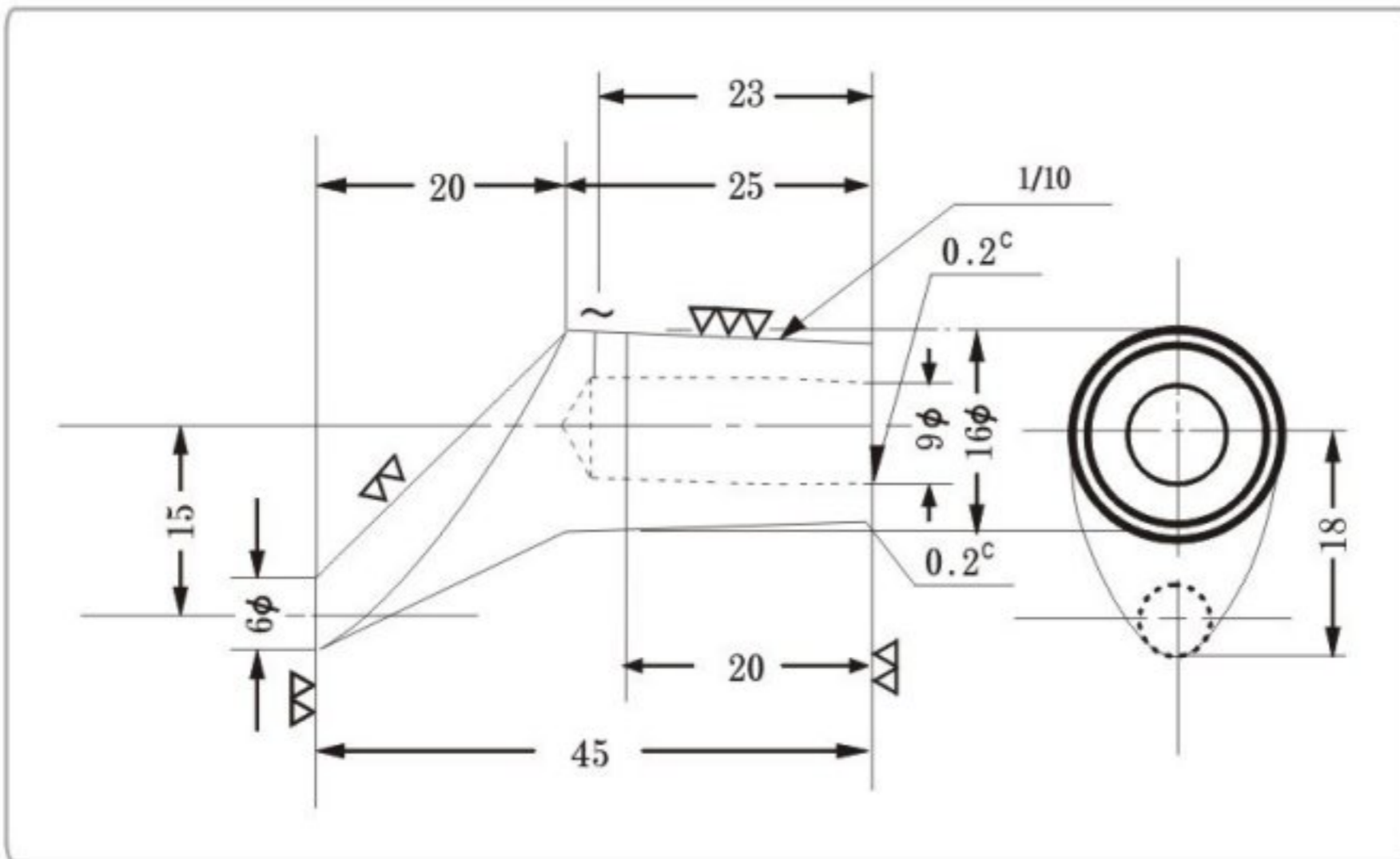
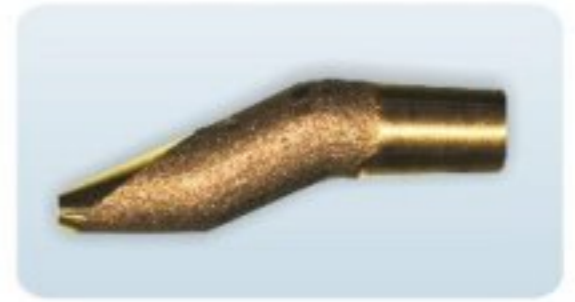

EK-C-1-3 鞋型  
Shoe type

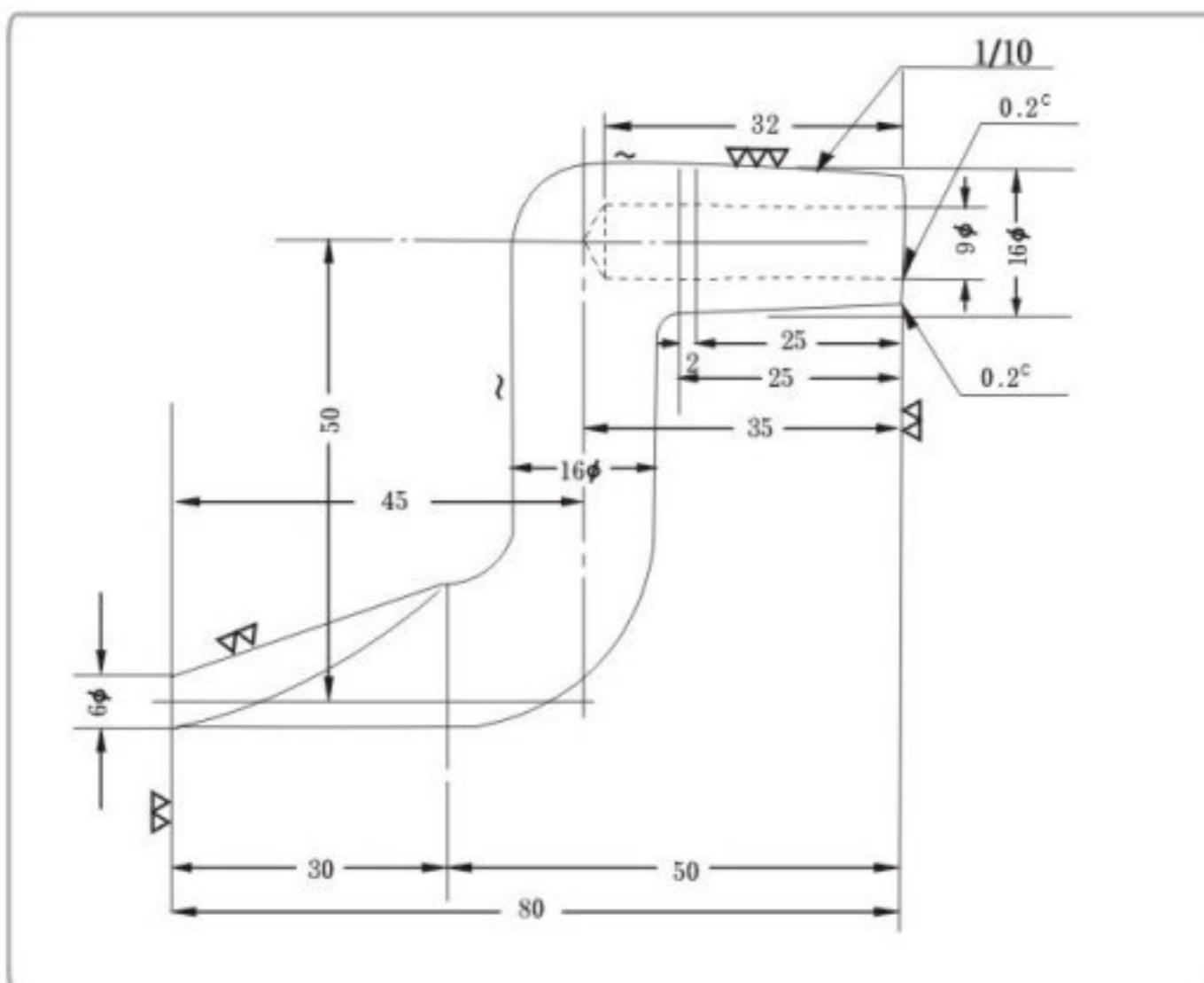

EK-C-2-3 大彎  
Two point bent(long)



備註：如有特殊規格，歡迎訂製。  
(If you need special specs, welcome to order custom-made)



# 瓷心 Ceramic Guide Pin

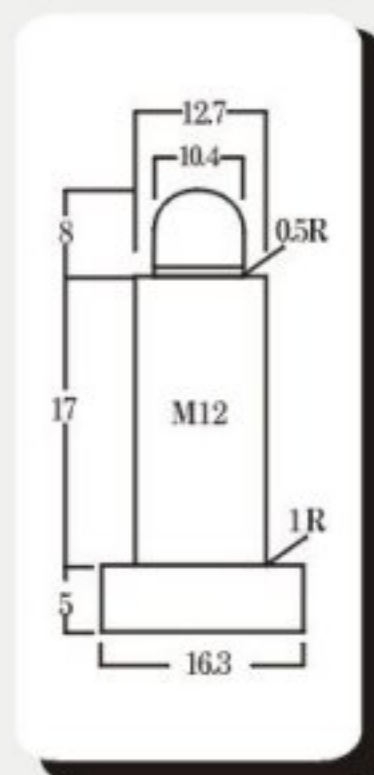
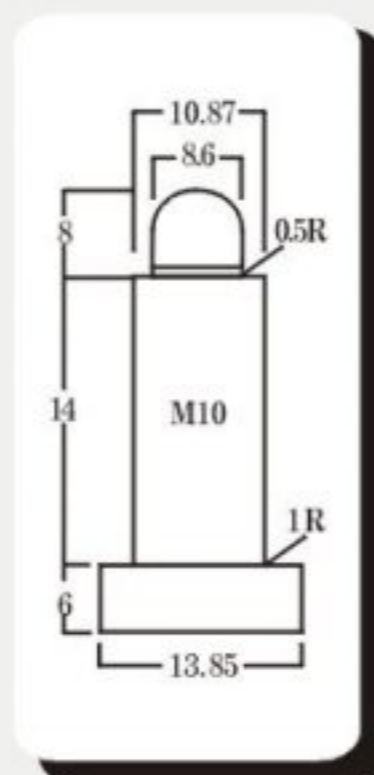
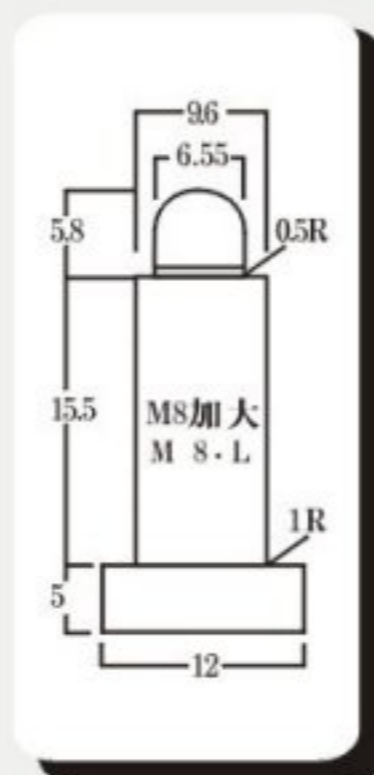
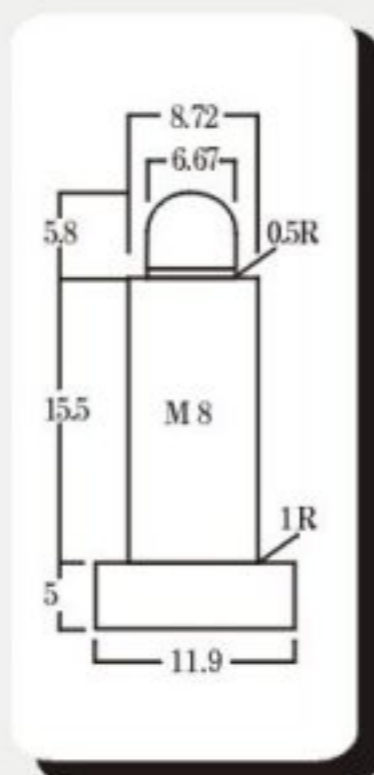
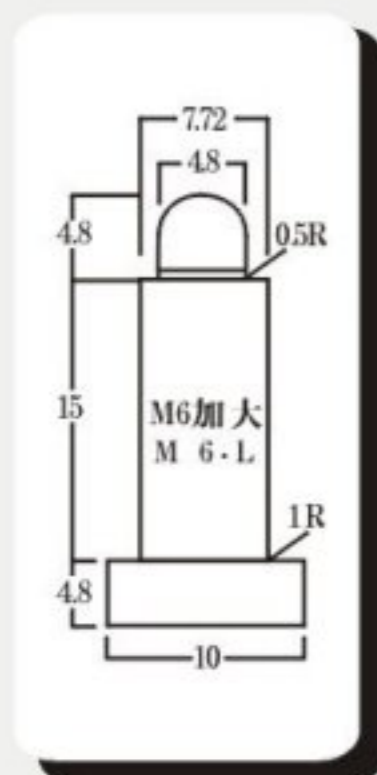
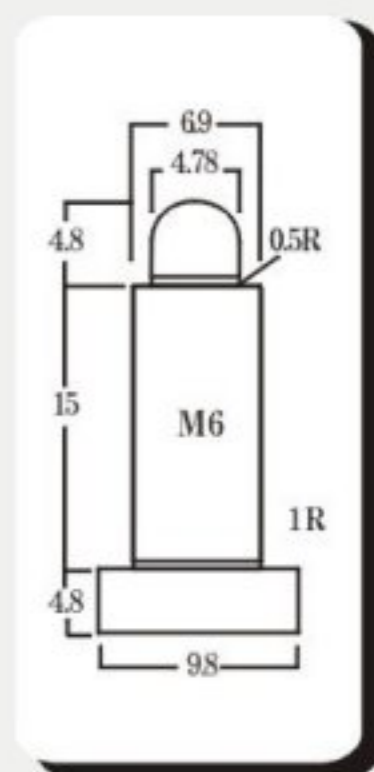
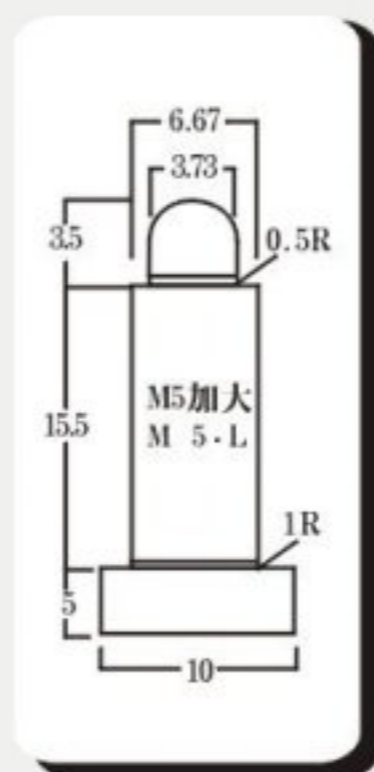
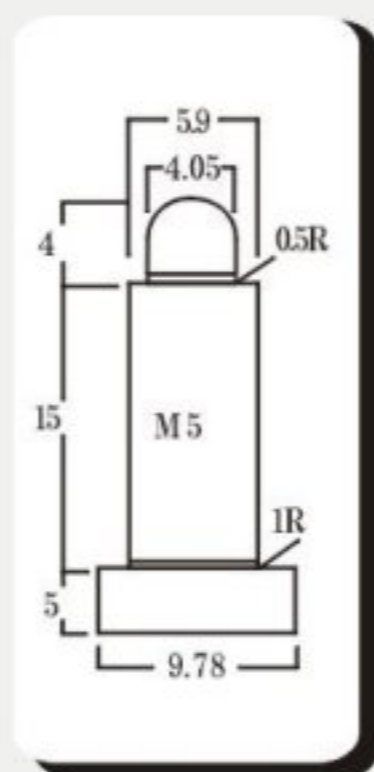
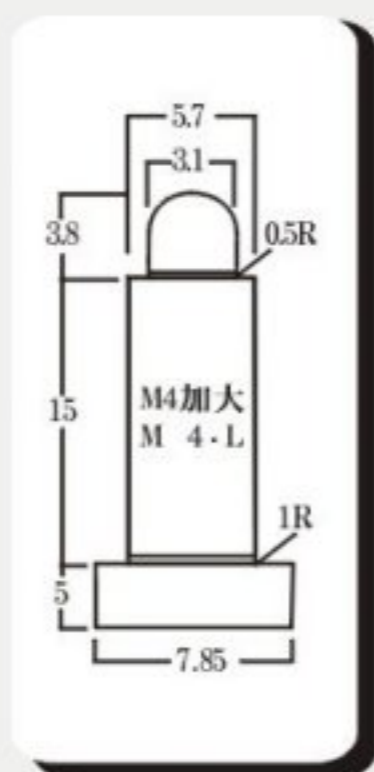
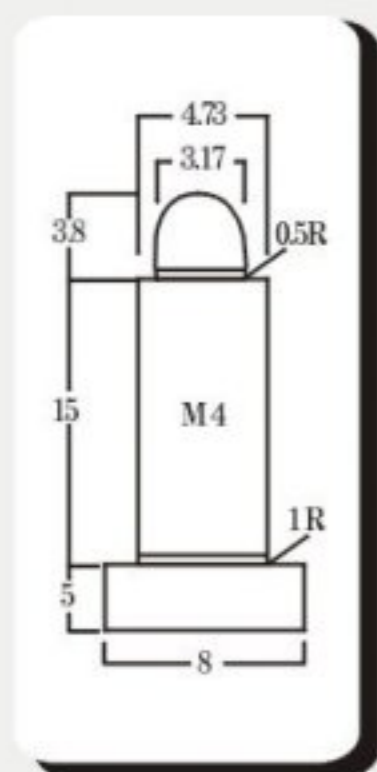

# 螺帽用電極 Nut for ceramic guide pin



瓷心銅座上蓋產品標準規格表列如下： 尺寸單位：mm  
(Specification) (Unit)

規格 Size	(M4)	(M5)	(M6)	(M8)	(M10)	(M12)
D1 <sup>φ</sup>	25	25	25	25	32	32
D2 <sup>φ</sup>	14	14	14	14	17.6	17.6
D3 <sup>φ</sup>	5	6	7	9	11	13

備註：如有特殊規格，歡迎訂製。  
(If you need special specs, welcome to order custom-made)

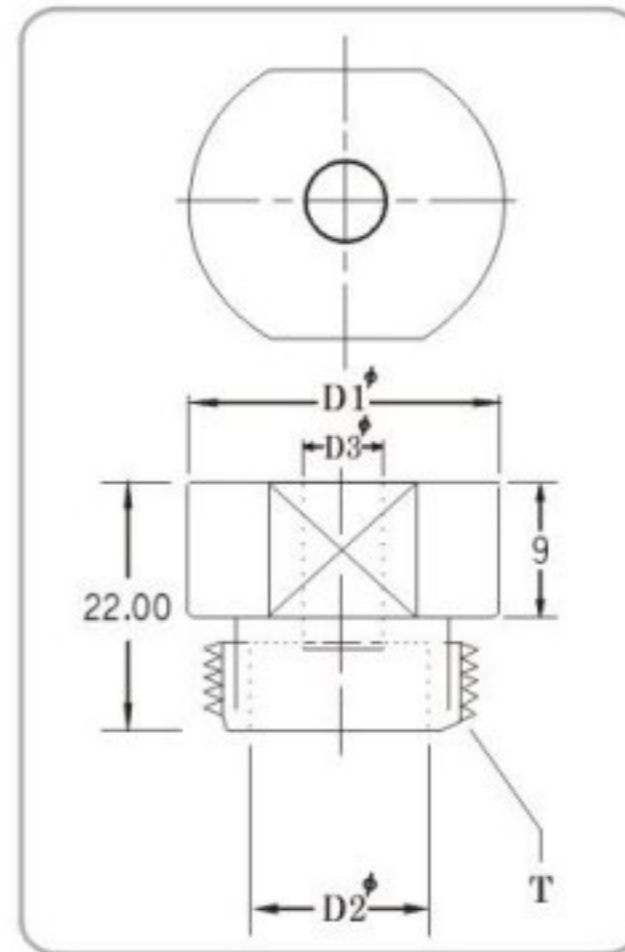

瓷心銅座下座產品標準規格表列如下： 尺寸單位：mm  
(Specification) (Unit)

(與黑鋼心下座同用 Share part with steel guide pin)

D <sup>φ</sup>	25	32
d <sup>φ</sup>	16	16

備註：如有特殊規格，歡迎訂製。  
(If you need special specs, welcome to order custom-made)

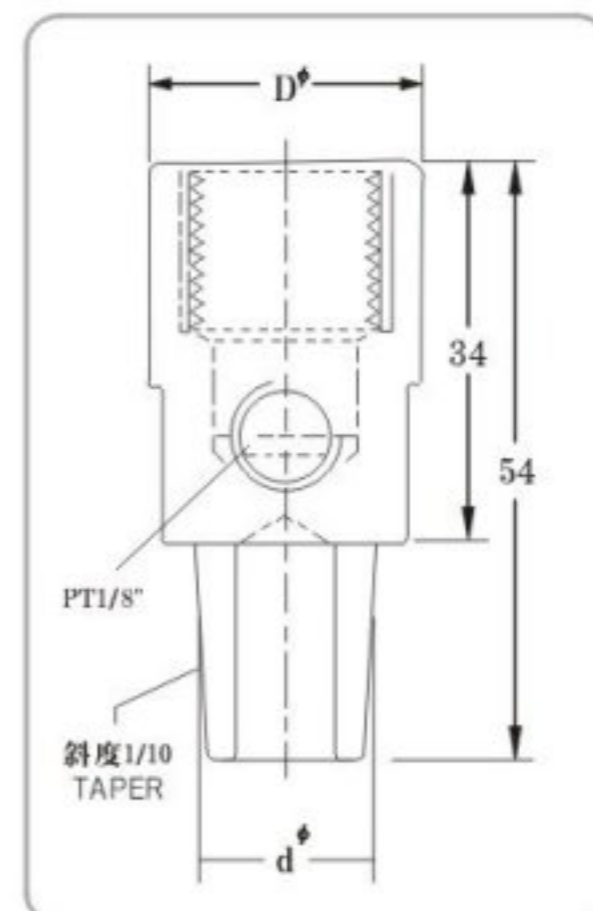

# 黑鋼心(瓷型)

# Steel guide pin(round)

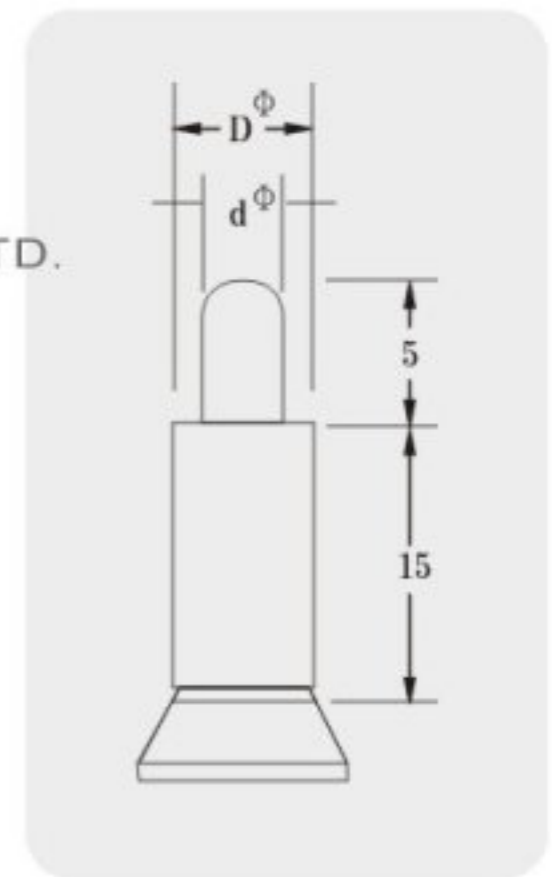

產品標準規格表列如下：  
(Specification)

尺寸單位：mm  
(Unit)

規格 Size	(M5)	(M6)	(M8)	(M10)
$D^\phi$	5.8	6.8	8.8	10.8
$d^\phi$	4	4.8	6.6	8.3

備註：如有特殊規格，歡迎訂製。  
(If you need special specs,welcome to order custom-made)

# 黑鋼心(尖型)

# Steel guide pin(sharpen)

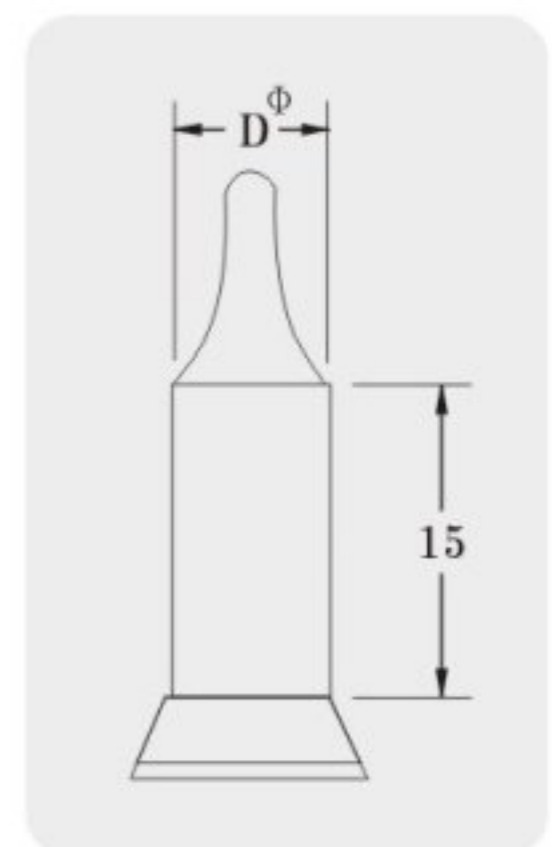

產品標準規格表列如下：  
(Specification)

尺寸單位：mm  
(Unit)

規格 Size	(M4)	(M5)	(M6)	(M8)	(M10)	(M12)
$D^\phi$	4.8	5.8	6.8	8.8	10.8	12.8

備註：如有特殊規格，歡迎訂製。  
(If you need special specs,welcome to order custom-made)

# 黑鋼心銅座上蓋

## Nut for steel guide pin



弘興企業有限公司 HORNG DE ENTERPRISE LTD.



產品標準規格表列如下： 尺寸單位：mm  
(Specification) (Unit)

規格 Size	(M4)	(M5)	(M6)	(M8)	(M10)	(M12)
D1 <sup>φ</sup>	25	25	25	25	32	32
D2 <sup>φ</sup>	14	14	14	14	17.6	17.6
D3 <sup>φ</sup>	5	6	7	9	11	13

備註：如有特殊規格，歡迎訂製。  
(If you need special specs, welcome to order custom-made)

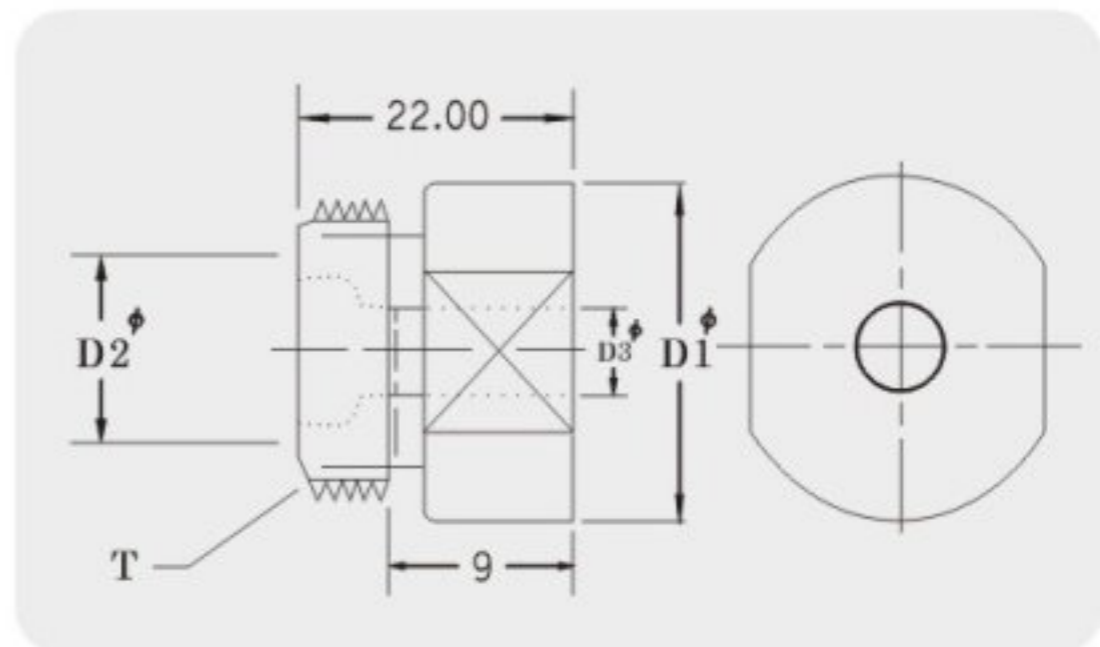

# 瓷管

## Bolt for ceramic pipe

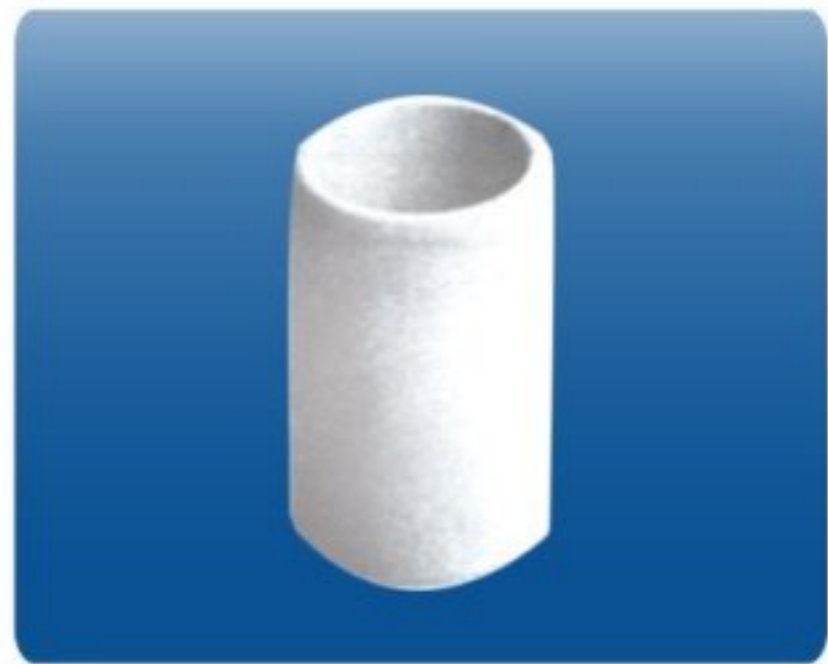

產品標準規格表列如下： 尺寸單位：mm  
(Specification) (Unit)

D <sup>φ</sup>	7.8	9.4	9.5	9.8	9.5	11	13	13.4
d <sup>φ</sup>	4.1	5	5.6	6	6.3	8	8.4	10
L	16.3	19.05	15	20	15	9	23	15.6

備註：如有特殊規格，歡迎訂製。  
(If you need special specs, welcome to order custom-made)

x2只



# 螺絲用電極 Bolt Electrode



瓷管銅座上蓋產品標準規格表列如下： 尺寸單位：mm  
(Specification) (Unit)

$d^\phi$	4.1	5.4	6.5	8.2	10.2
$D^\phi$	8	9.5	10	11	13.6

備註：如有特殊規格，歡迎訂製。  
(If you need special specs, welcome to order custom-made)

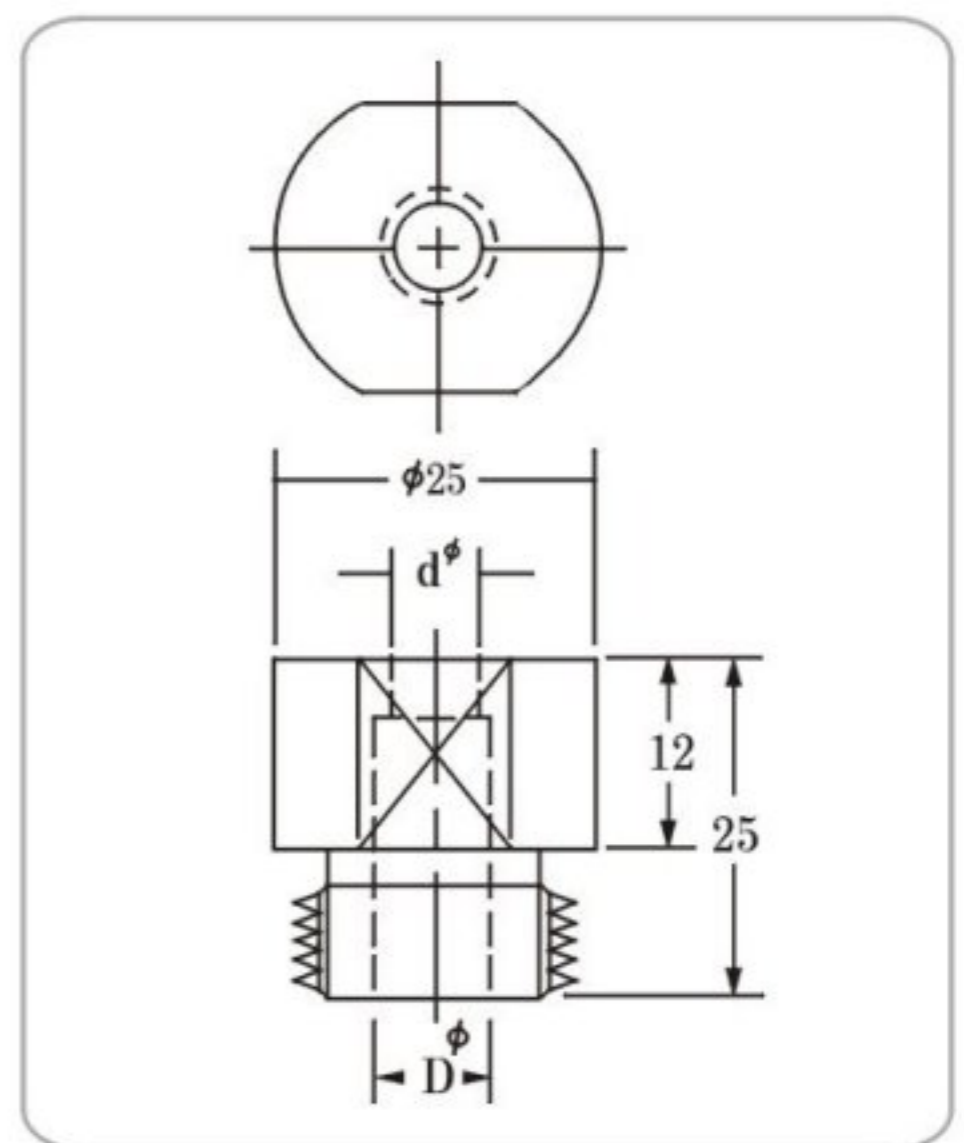

瓷管銅座下座產品標準規格表列如下： 尺寸單位：mm  
(Specification) (Unit)

$D^\phi$	25	32
$d^\phi$	16	16

備註：如有特殊規格，歡迎訂製。  
(If you need special specs, welcome to order custom-made)

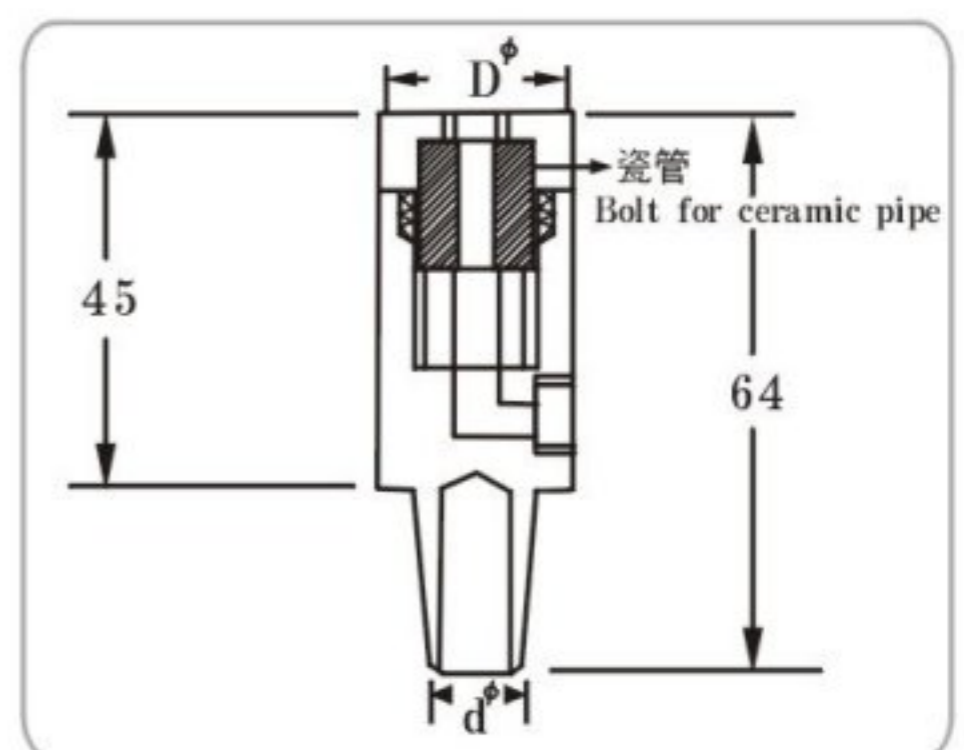

# 通水銅 Straight Holder

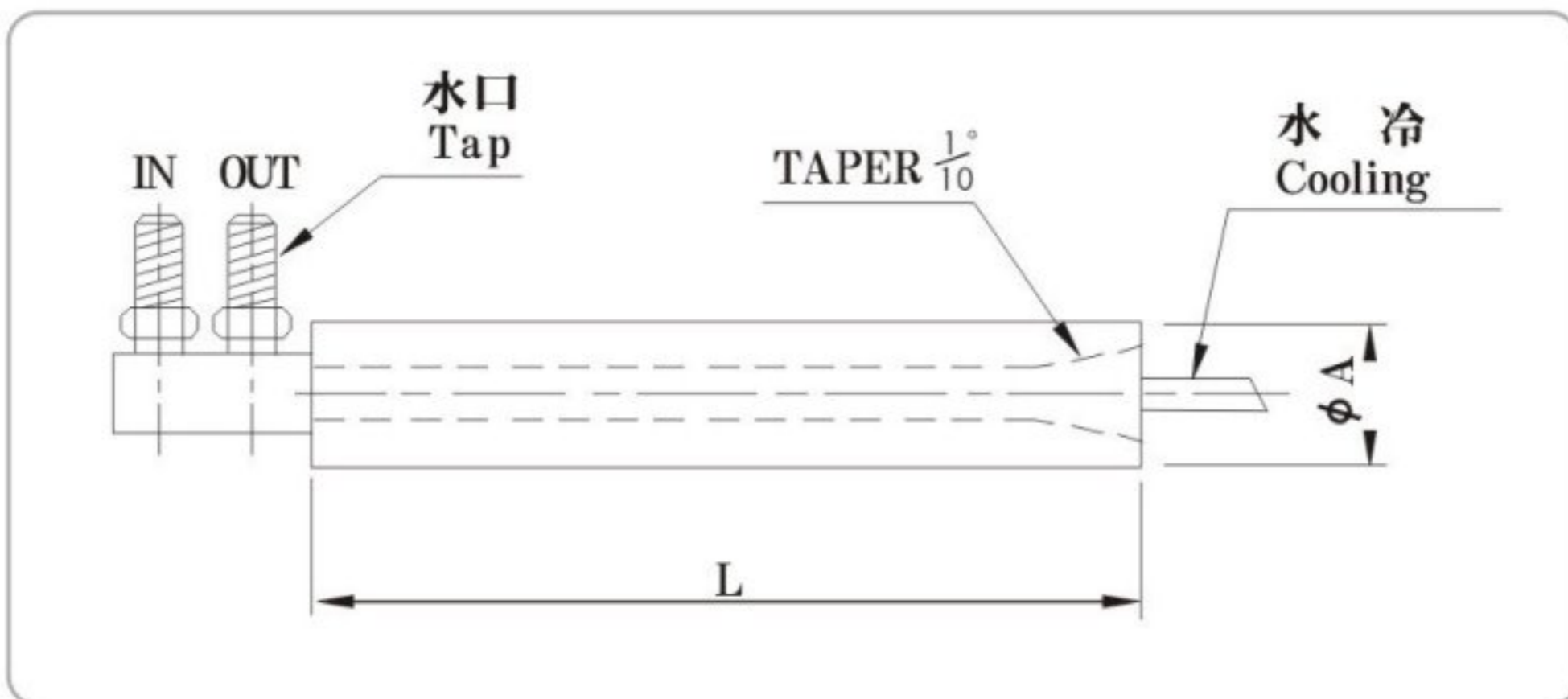

產品標準規格表列如下：  
(Specification)

尺寸單位：mm  
(Unit)

A	3/4"	3/4"	3/4"	1"	1"	1"	1"	1"	1"	1"	1 1/4"	1 1/4"
L	200	250	300	150	180	200	250	300	350	400	200	250
TAPER	13 ‰	13 ‰	13 ‰	16 ‰	16 ‰	16 ‰	16 ‰	16 ‰	16 ‰	16 ‰	16 ‰	16 ‰
											19 ‰	19 ‰

備註：如有特殊規格，歡迎訂製。  
(If you need special specs, welcome to order custom-made)

# L 型通水銅 L-Holder

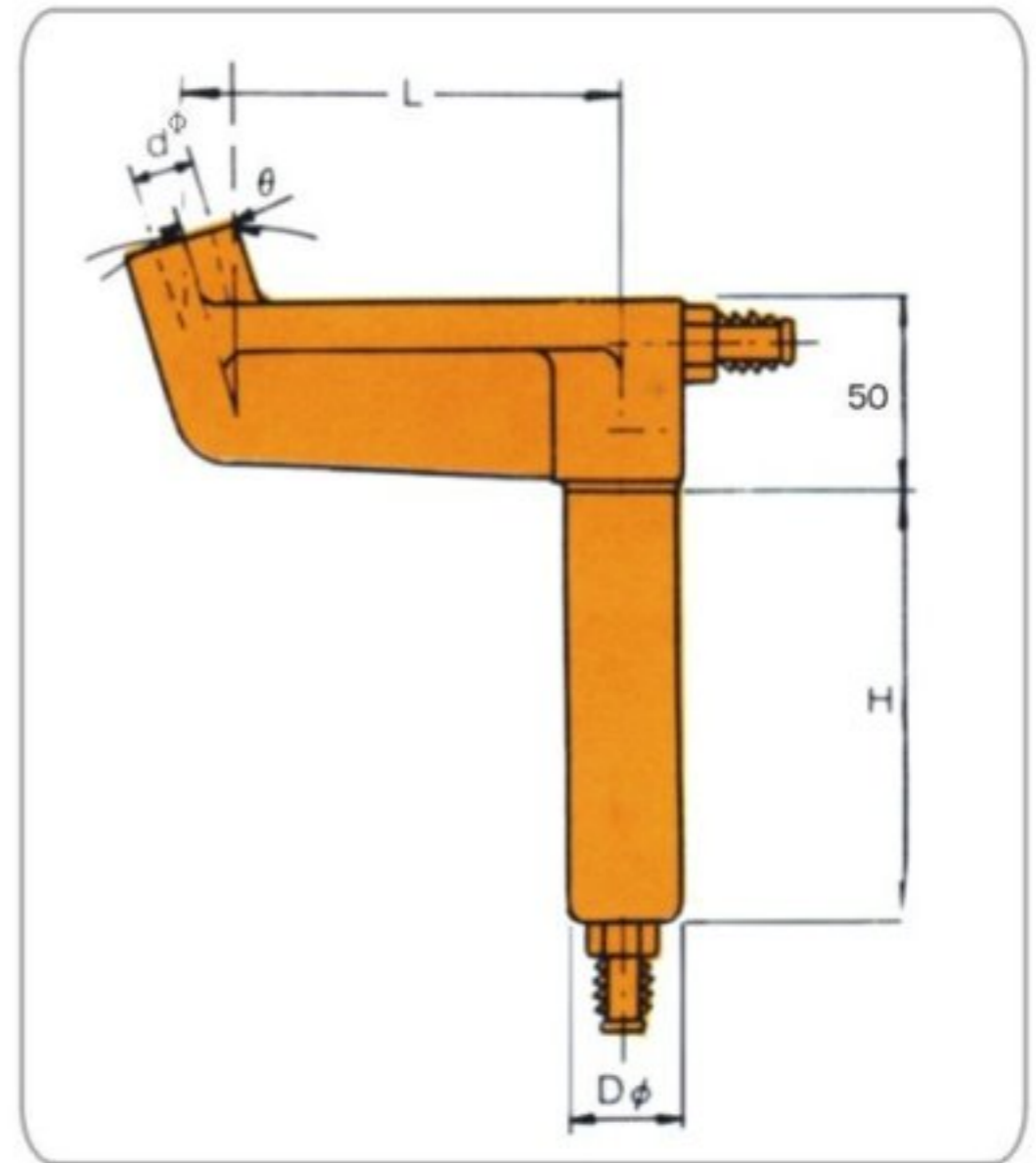
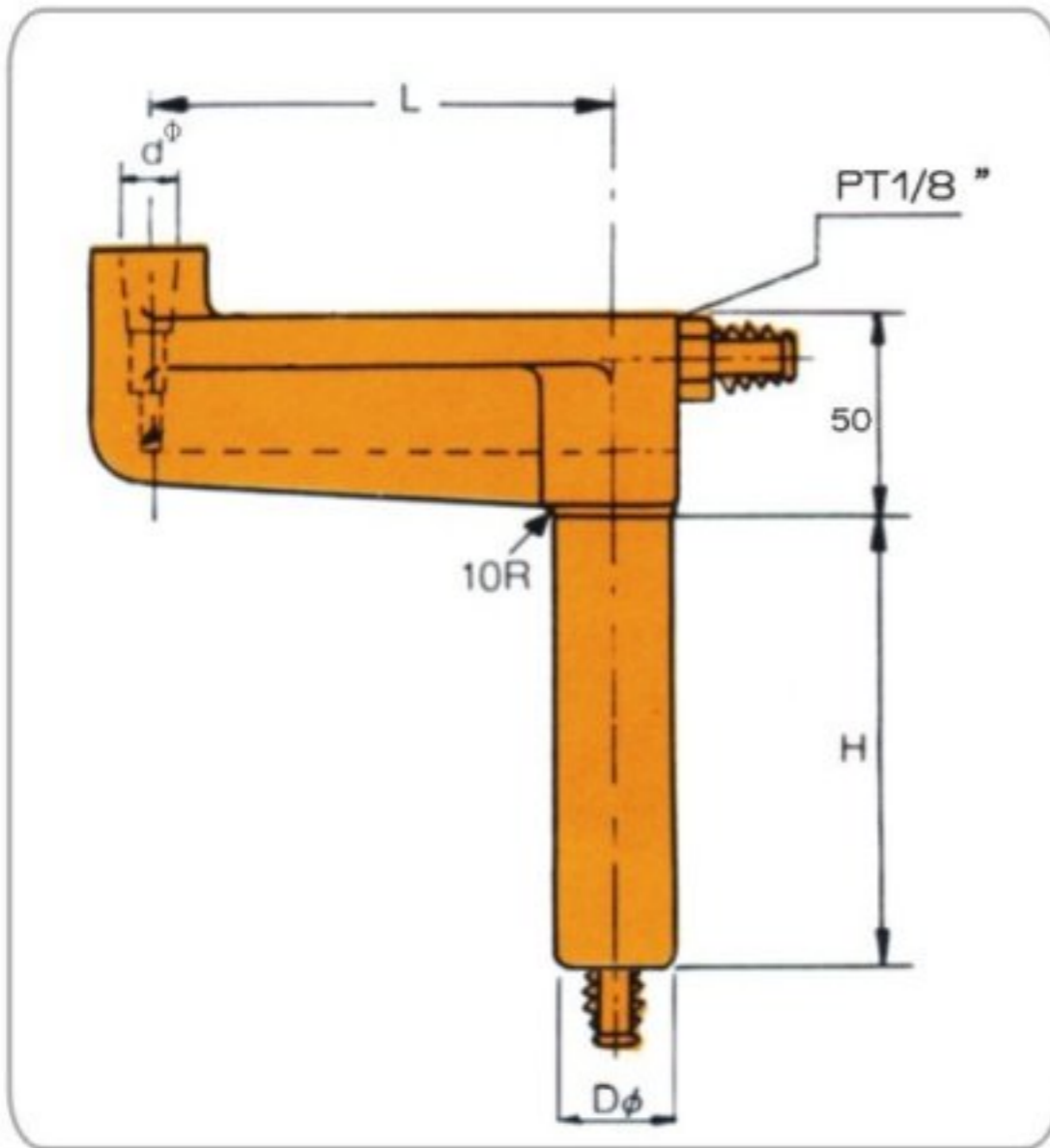
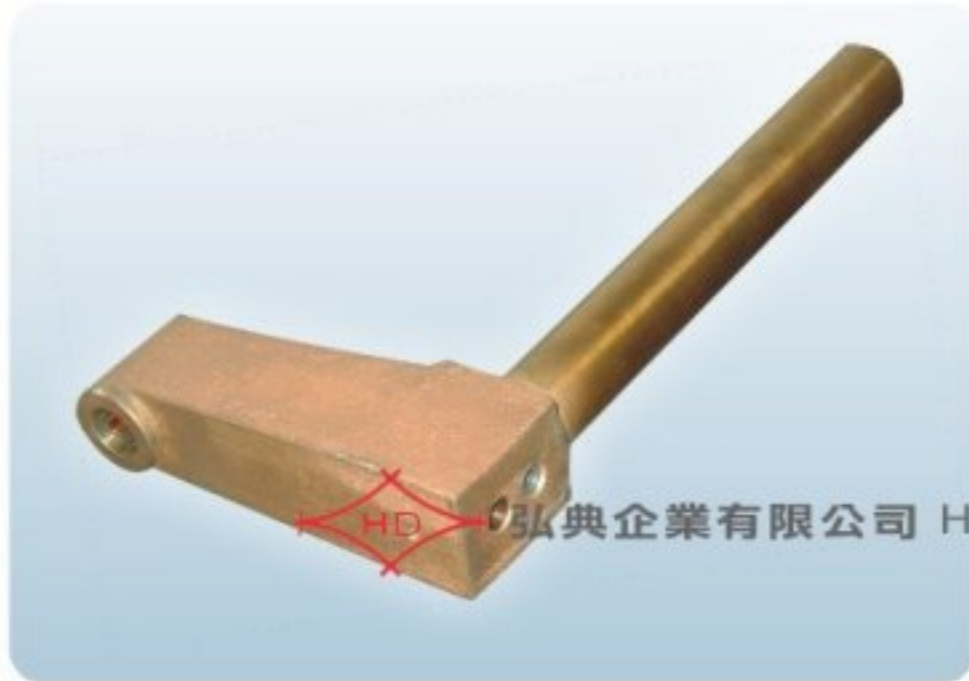

產品標準規格表列如下：  
(Specification)

尺寸單位：mm  
(Unit)

$D^\phi$	1"	1"	1"	1 $\frac{1}{4}$ "	1 $\frac{1}{4}$ "	1"	1"	1 $\frac{1}{4}$ "	1"	1"	1 $\frac{1}{4}$ "	1"	1 $\frac{1}{4}$ "
$\theta$	90°	90°	90°	90°	90°	15°	15°	15°	90°	90°	90°	15°	15°
L	40	50	60	50	60	50	70	50	90	100	100	100	100
H	135	195	145	195	170	195	175	195	145	195	195	195	175
$d^\phi$	$\frac{5}{8}$ "	$\frac{5}{8}$ "	$\frac{5}{8}$ "	$\frac{5}{8}$ "	$\frac{5}{8}$ "	$\frac{5}{8}$ "	$\frac{5}{8}$ "	$\frac{5}{8}$ "	$\frac{5}{8}$ "	$\frac{5}{8}$ "	$\frac{5}{8}$ "	$\frac{5}{8}$ "	$\frac{5}{8}$ "

備註：如有特殊規格，歡迎訂製。  
(If you need special specs, welcome to order custom-made)

# T 型通水銅 T-Holder

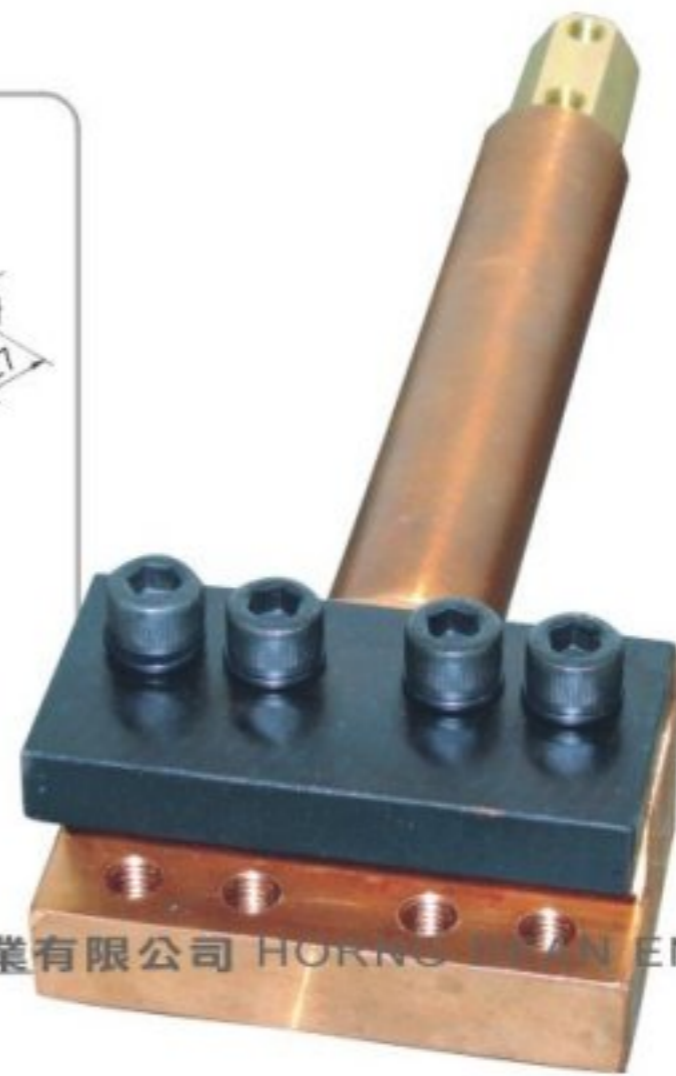
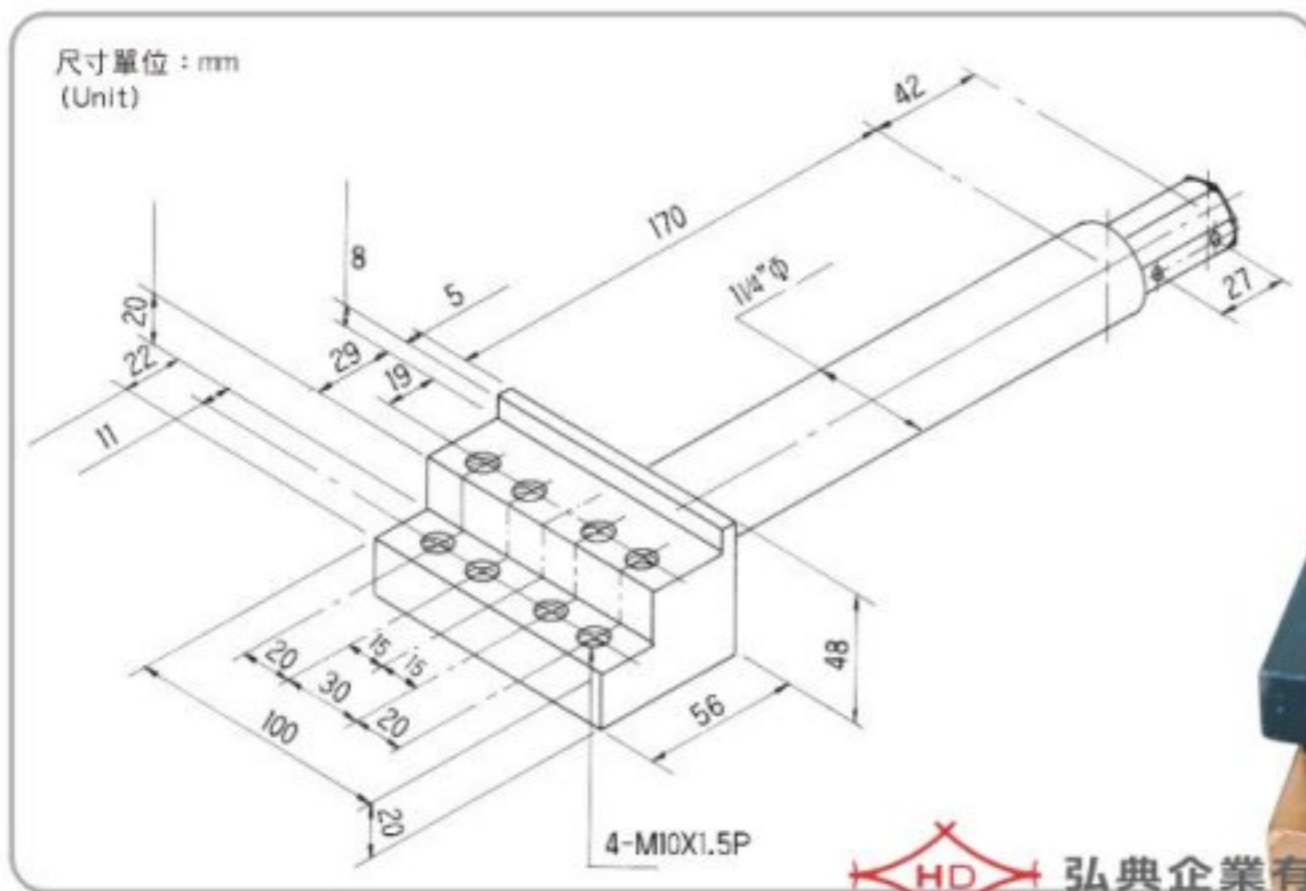

弘典企業有限公司 HORNG DEAN ENTERPRISE LTD.

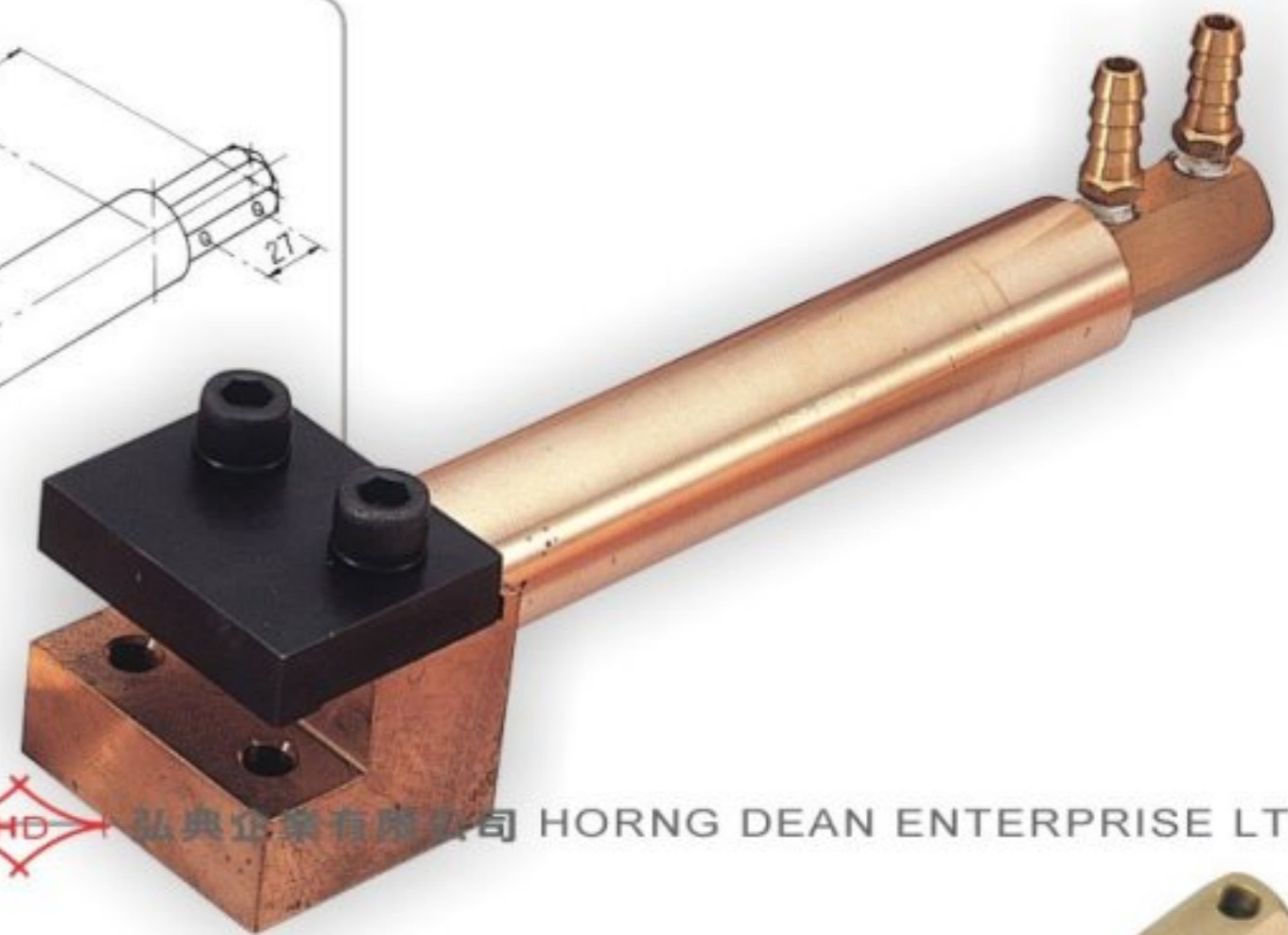
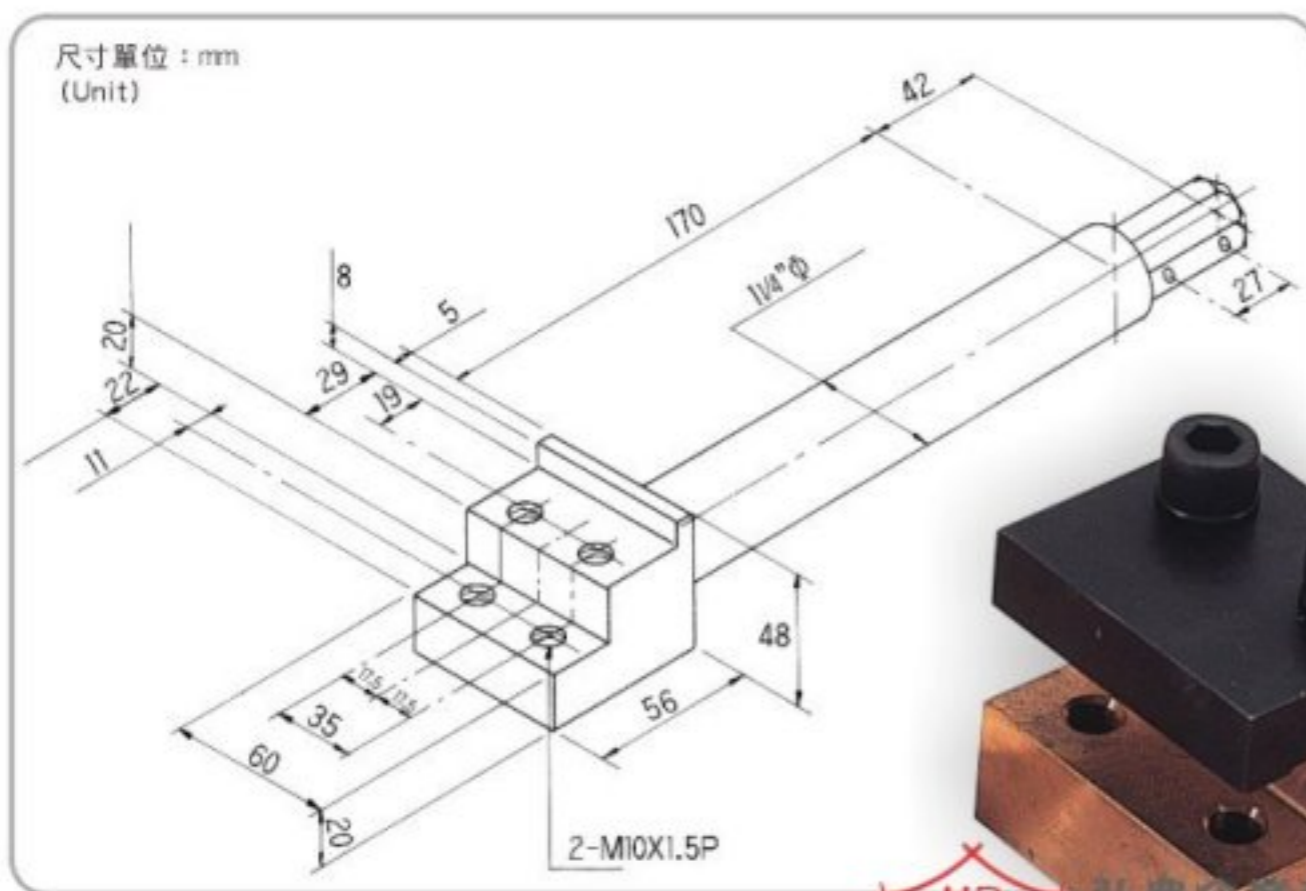

弘典企業有限公司 HORNG DEAN ENTERPRISE LTD.

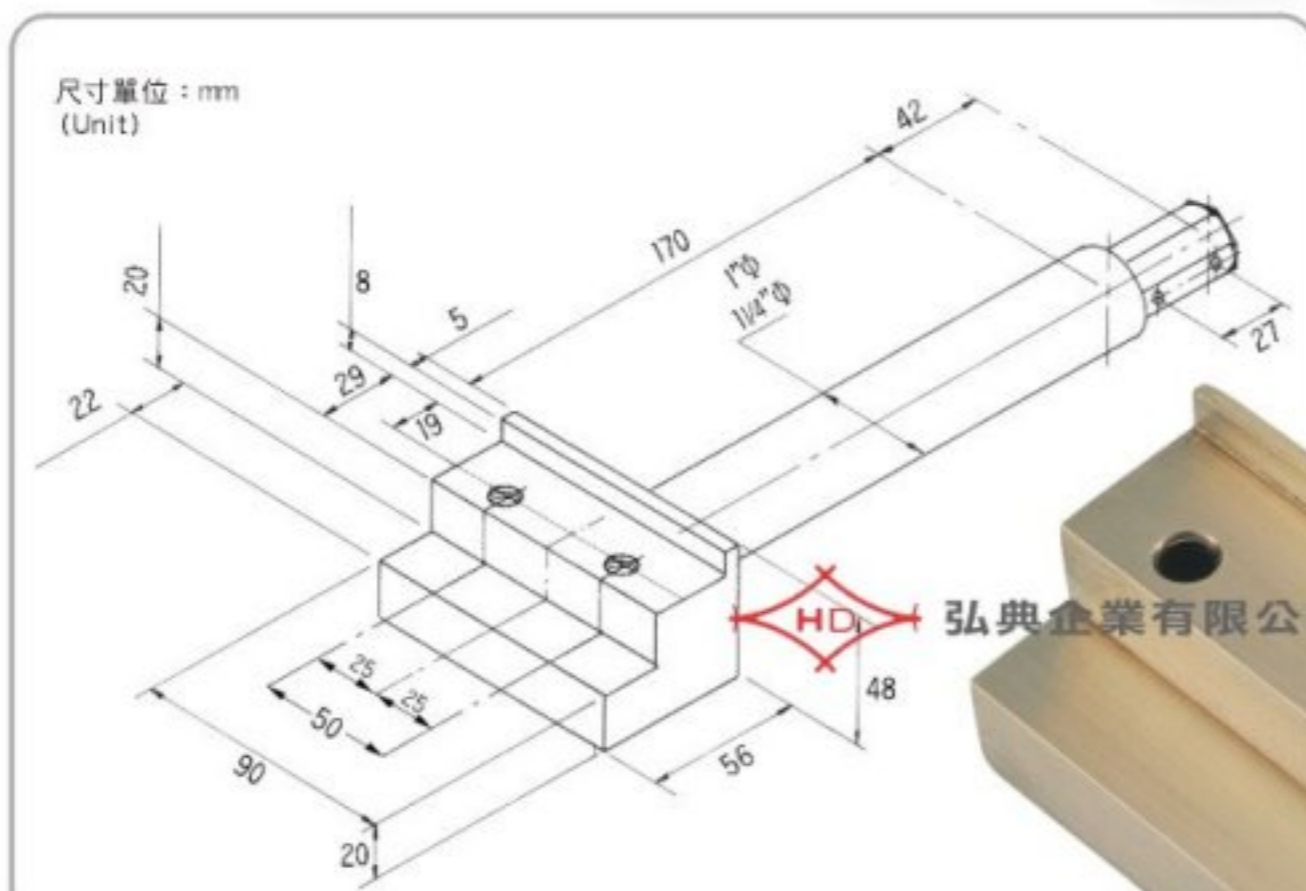

弘典企業有限公司 HORNG DEAN ENTERPRISE LTD.



# 熔接機周邊配件 **A Section of welder**

## 青銅條 BSBM Pillar



弘典企業有限公司 HORNG DEAN ENTERPRISE LTD.

材質：青銅(BSBM)

型式 Type	規格 Specifications	通水銅 Size	長度L (mm)
120-60T	ø60	ø25	225,265
160-70T	ø70	ø32	255,295
200-80T	ø80	ø32	295

備註：如有特殊規格，歡迎訂製。

(If you need special specs, welcome to order custom-made)

## 冷卻用、目視用 水流動表

Use To Cooling And Watch For Flower

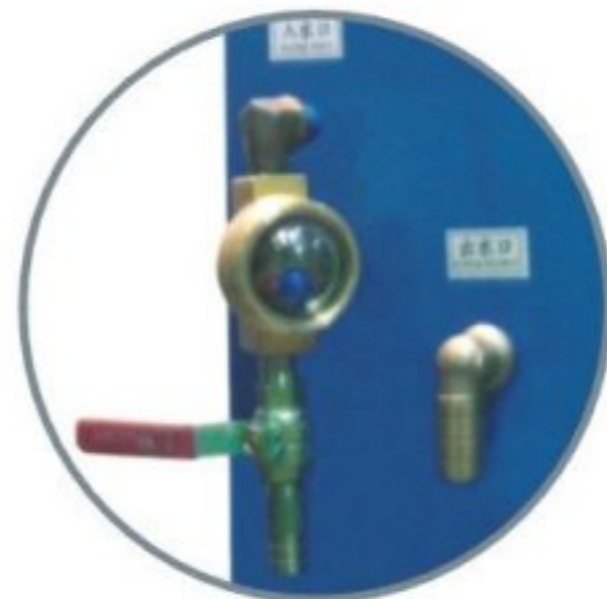
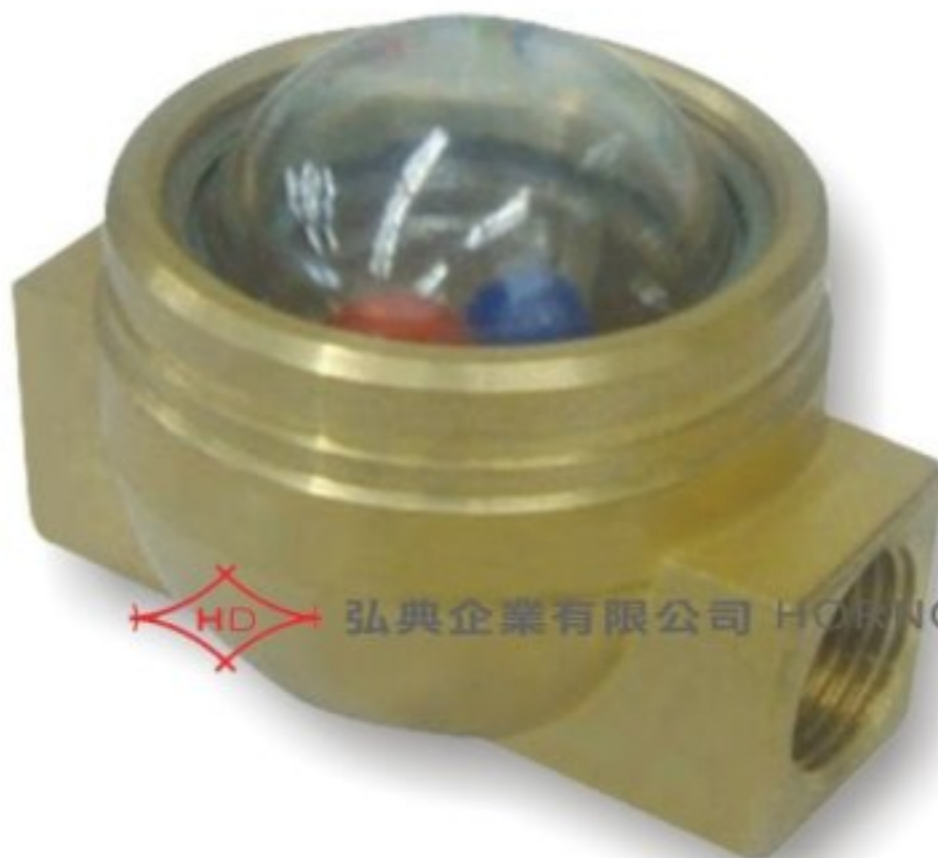

弘典企業有限公司 HORNG DEAN ENTERPRISE LTD.

重量：500g

型式 Type	規格 Specifications
921012	1/4"NPT
921013	3/8"NPT
921014	1/2"NPT

# 銅、鋁、鋼 重量計算表

## Copper、Aluminum、Steel Weight Calculation table

品名 (Name)	計算公式 (Calculation formula)
丸，銅條 (Round,copper bar)	直徑x直徑x0.006723 (Diameter x Diameter x 0.006723)
四角，銅條 (Square,copper bar)	厚度x厚度x0.00856 (Thickness x Thickness x 0.00856)
六角，銅條 (Hexagon,copper bar)	直徑x直徑x0.007412 (Diameter x Diameter x 0.007412)
長方形，銅板 (Rectangle,copper plate)	厚度x厚度x0.00856 (Thickness x Thickness x 0.00856)
CC合金，條 (CC alloy, Bar)	直徑x直徑x0.00713 (Diameter x Diameter x 0.00713)
CC合金·板 (CC alloy, Plate)	厚度x厚度x0.009077 (Thickness x Thickness x 0.009077)
丸，鋁條 (Round,Aluminum bar)	直徑x直徑x0.002152 (Diameter x Diameter x 0.002152)

品名 (Name)	計算公式 (Calculation formula)
四角，鋁條 (Square,Aluminum bar)	厚度x厚度x0.002742 (Thickness x Thickness x 0.002742)
六角，鋁條 (Hexagon,Aluminum bar)	直徑x直徑x0.002372 (Diameter x Diameter x 0.002372)
長方形，鋁條 (Rectangle,Aluminum bar)	厚度x厚度x0.002742 (Thickness x Thickness x 0.002742)
丸，鋼條 (Round,Steel bar)	直徑x直徑x0.00617 (Diameter x Diameter x 0.00617)
四角，鋼條板 (Square,Steel bar plate)	厚度x厚度x0.00785 (Thickness x Thickness x 0.00785)
六角，鋼條 (Hexagon,Steel bar)	直徑x直徑x0.0068 (Diameter x Diameter x 0.0068)

# 軟鋼板點焊熔接條件表

## Condition table of soft steel plate welding

板厚 Thickness	電極先端徑 Tip of electrode	點間距離 Distance	最良好條件 The best condition				中等條件 Middle level conditor				普通條件 Normal condition			
			熔接時間 Weid time	加壓力 Welding force	熔接電流 Welding current	強度士14% Strength	熔接時間 Weid time	加壓力 Welding force	熔接電流 Welding current	強度士14% Strength	熔接時間 Weid time	加壓力 Welding force	熔接電流 Welding current	強度士14% Strength
M/M	M/M	M/M	HZ	KG	A	KG	HZ	KG	A	KG	HZ	KG	A	KG
0.4	3.2	8	5	115	5,200	180	10	75	4,500	160	20	40	3,500	125
0.5	3.5	9	6	135	6,000	240	11	90	5,000	210	24	45	4,000	175
0.6	4.0	10	7	150	6,600	300	13	100	5,500	180	26	50	4,300	225
0.8	4.5	12	8	190	7,800	440	15	125	6,500	400	30	60	5,000	355
1.0	5.0	18	10	225	8,800	610	20	150	7,200	540	36	75	5,600	530
1.2	5.5	20	12	270	9,800	785	23	175	7,700	680	40	85	6,100	650
1.4	6.0	23	14	305	10,600	930	26	210	8,500	850	46	100	6,600	780
1.6	6.3	27	16	360	11,500	1,060	30	240	9,100	1,000	52	115	7,000	925
1.8	6.7	31	18	410	12,500	1,300	33	175	9,700	1,180	58	130	7,500	1,100
2.0	7.0	35	20	470	13,300	1,450	36	300	10,300	1,370	64	150	8,000	1,085
2.4	7.8	40	24	580	15,000	1,850	44	370	11,300	1,770	77	180	8,600	1,085
2.8	8.5	45	28	700	16,200	2,380	52	430	12,100	2,300	95	220	9,400	2,175
3.2	9.0	50	32	820	27,400	3,100	60	500	12,900	2,850	105	260	10,000	2,665